

1/8th Scale 4WD Gas Powered Racing Car

# P8.0

## MANUALE DI MONTAGGIO

## INSTRUCTION MANUAL

[www.rcinfos.com](http://www.rcinfos.com)



# MOTONICA®

### ATTENZIONE!

Questo modello non è un giocattolo.

- Si consiglia ai principianti di apprendere dai modellisti più esperti tutti i suggerimenti necessari per montare correttamente e pilotare senza rischi il modello.
- Assemblare questo modello in posti lontano dalla portata dei bambini!
- Rispettare sempre le necessarie misure di sicurezza prima di adoperare il modello. Siete i soli responsabili del montaggio e del funzionamento del modello.
- La prestazione del modello potrebbe essere sottovalutata dal pilota inesperto, e causare danni a cose e/o persone.
- Conservare questo manuale anche una volta completato il montaggio.

### WARNING!

This radio control model is not a toy.

- First-time builders should seek the advice of experienced modelers before beginning assembly and if they do not fully understand any part of the construction.
- Assemble this kit only in places out of children's reach!
- Take care before operating this model. You are responsible for this model's assembly and safe operation!
- The extreme performance of the model could be underestimated by inexperienced drivers and could damage goods and/or people.
- Always keep this instruction manual ready at hand for quick reference, even after completing the assembly.

**ATTREZZI PER IL MONTAGGIO (NON INCLUSI)  
TOOLS NEEDED FOR ASSEMBLY (NOT INCLUDED)**

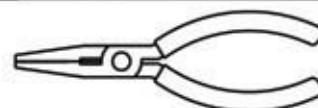

PINZA A BECCHILUNGH  
NEEDLE NOSE PLIERS

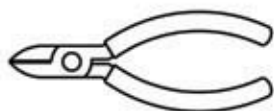

TRONCHESI  
WIRE CUTTERS

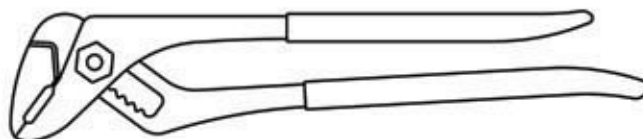

PINZA REGOLABILE  
ADJUSTABLE PLIERS

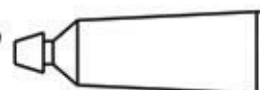

GRASSO  
GREASE

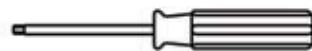

BRUGOLA A CACCIAVITE mm.1,5/2/2,5/3  
HEX WRENCH mm. 1,5/2/2,5/3

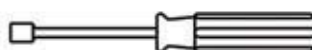

CACCIAVITE A BUSSOLA 5mm.  
BOX WRENCH 5mm.

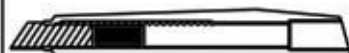

TAGLIERINO  
CUTTER

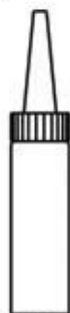

COLLA CIANOACRILICA  
INSTANT GLUE



OLIO AL SILICONE (INCLUSO)  
SILICON OIL (INCLUDED)



OLIO (TIPO WD40)  
LUBRICANT (WD40 OR SIMILAR)

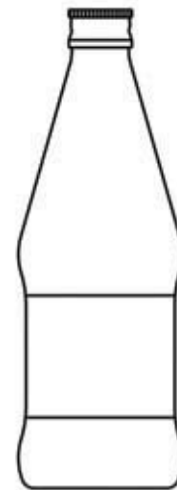

TRIELINA  
SOLVENT

**PARTI PER IL COMPLETAMENTO E AVVIAMENTO DEL MODELLO (NON INCLUSI)  
PARTS FOR MODEL COMPLETION AND START (NOT INCLUDED)**

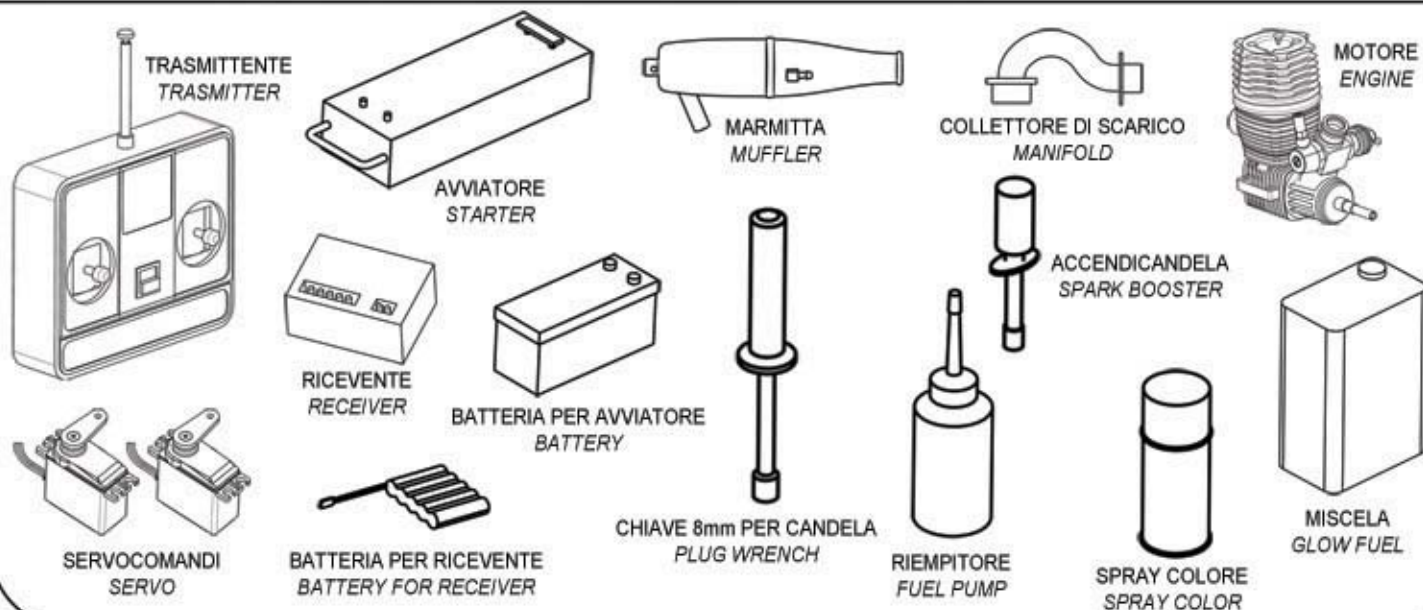

TRASMETTENTE  
TRANSMITTER

AVVIATORE  
STARTER

MARMITTA  
MUFFLER

COLLETTORE DI SCARICO  
MANIFOLD

MOTORE  
ENGINE

RICEVENTE  
RECEIVER

BATTERIA PER AVVIATORE  
BATTERY

ACCENDICANDELA  
SPARK BOOSTER

SERVOCOMANDI  
SERVO

BATTERIA PER RICEVENTE  
BATTERY FOR RECEIVER

CHIAVE 8mm PER CANDELA  
PLUG WRENCH

RIEMPITORE  
FUEL PUMP

SPRAY COLORE  
SPRAY COLOR

MISCELA  
GLOW FUEL

**LEGENDA**

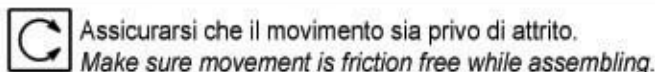
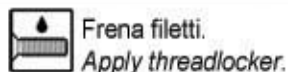

PRIMA DI INIZIARE IL MONTAGGIO  
ELIMINARE IL GRASSO CONTENUTO NEI CUSCINETTI  
IMMERGENDOLI IN TRIELINA O AVIO.  
LASCIARE ASCIUGARE E LUBRIFICARE CON OLIO  
(CONSIGLIATO WD40)

BEFORE ASSEMBLING PLUNGE THE BEARING IN SOLVENT  
TO ELIMINATE THE GREASE.  
THEN APPLY WD40 LUBRICANT OR EQUIVALENT.

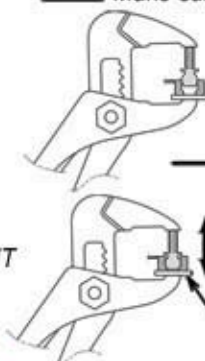

Per inserimento Sfere 11-011 usare,  
Pinza regolabile o Morsa.  
To insert the 11-011 balls, use adjustable  
pliers or vice.

Nel caso il movimento delle sfere risultasse limitato,  
agire con maggior pressione.  
If balls smoothness is poor, press more.

Supporto liscio per non rovinare la plastica.  
Protection plate to prevent plastic damage.

01

### Assale anteriore Front Shaft



O-Ring  
Ø12x1,5  
02-011\_\_x1



Cuscinetto  
Ball Bearing  
Ø12xØ18x4  
11-010\_\_x2



Distanziale  
Collar  
Ø6xØ10x1,5  
05-041\_\_x2

02

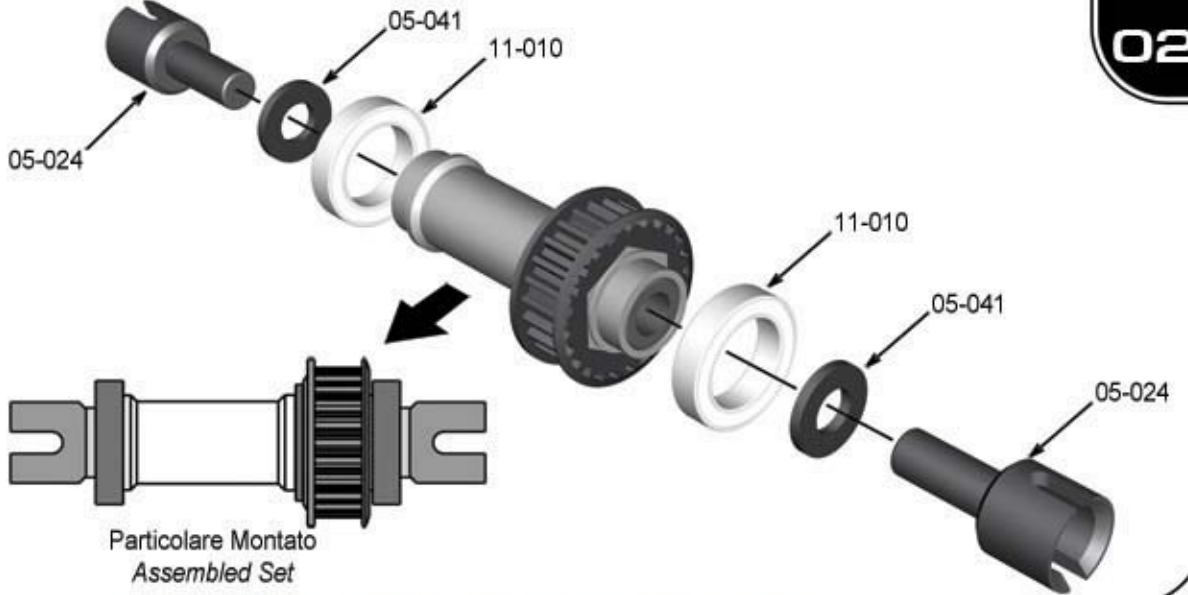

[www.rcinfos.com](http://www.rcinfos.com)

03

### Pullegge Pulleys

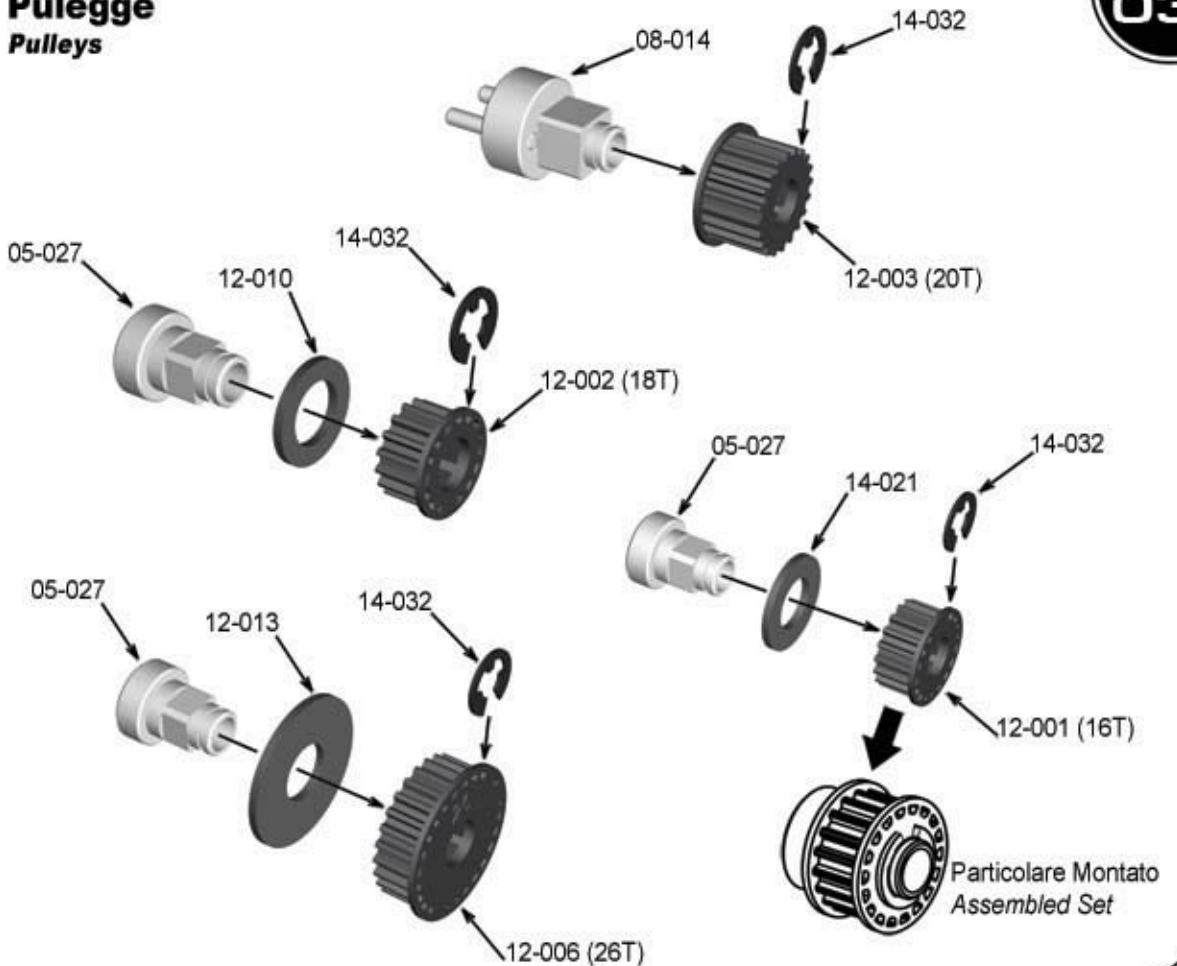

E-Ring Ø7  
14-032\_\_x4

04

**Barra Antirollio Ant.**  
**Front Stabilizer Bar**

Posizione barre A/R consigliata nella prima fase di montaggio.  
Position of the stabilizer bar suggested during the first assembly phase.

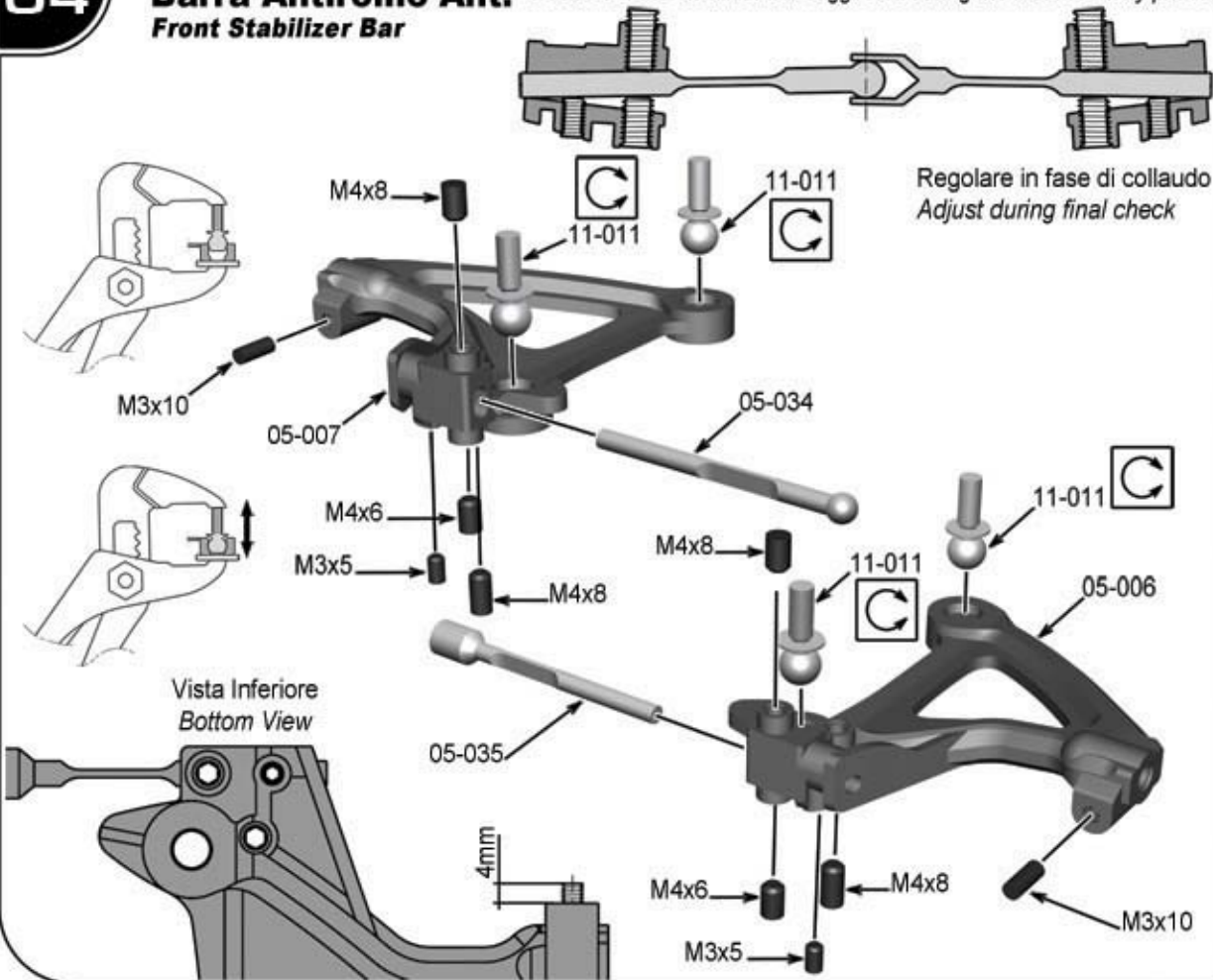

14-020  
M3x10 \_\_\_x2

14-024  
M4x6 \_\_\_x2

14-025  
M4x8 \_\_\_x4

14-019  
M3x5 \_\_\_x2

11-011  
M4 \_\_\_x4

[www.rcinfos.com](http://www.rcinfos.com)

05

**Spalline Anteriori e Paraurti**  
**Front Bulkheads and Bumper**

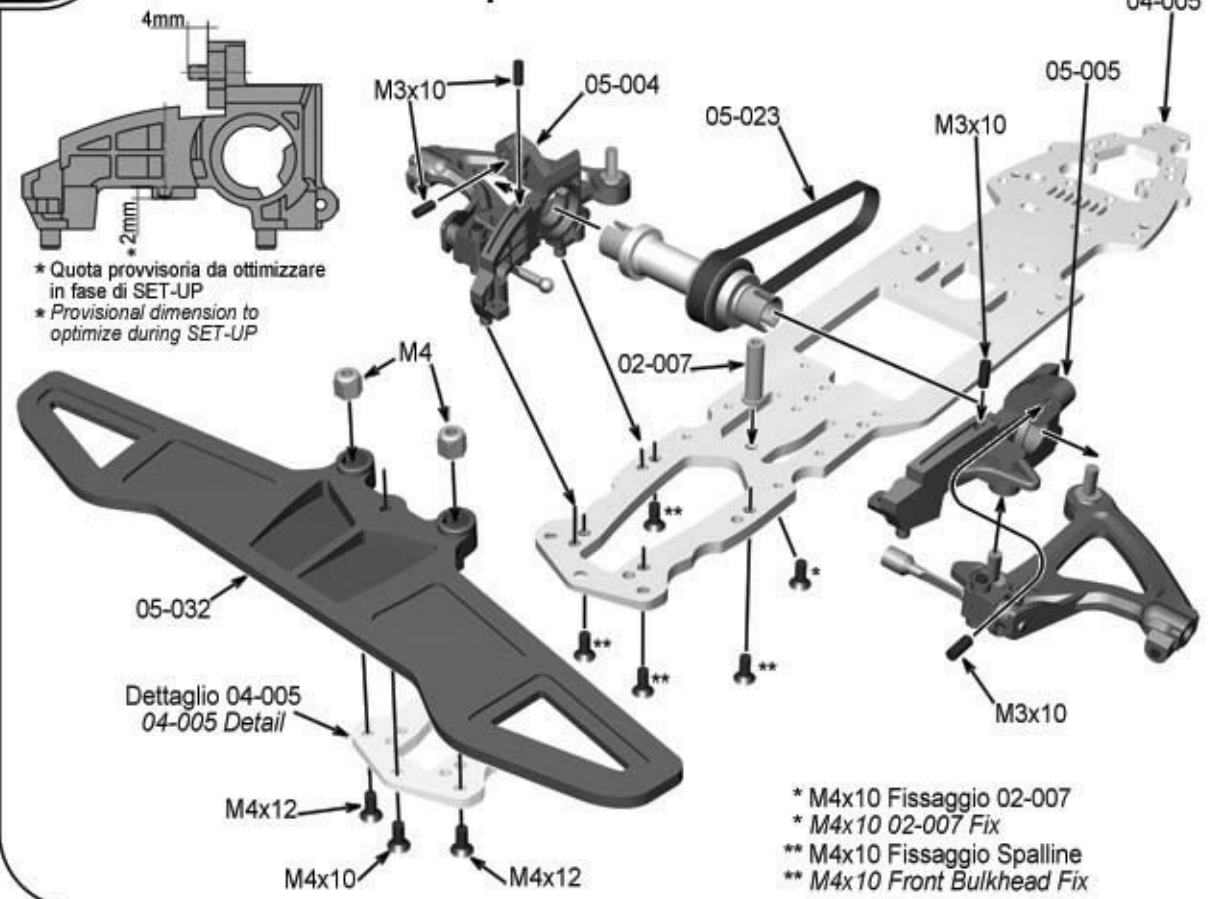

Dado AB M4  
Nylon nut.  
14-017 \_\_\_x2

TS  
14-005  
M4x10 \_\_\_x6

TS  
14-006  
M4x12 \_\_\_x2

14-020  
M3x10 \_\_\_x4

### Salva Servo Servo Saver



O-Ring  
Ø12x15  
02-011\_\_x1

Particolare Montato  
Assembled Set

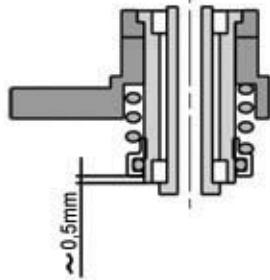

[www.rcinfos.com](http://www.rcinfos.com)

### Tirante Sterzo x2 Tie - Rod



11-004\_\_x4



14-022  
M3x20\_\_x1

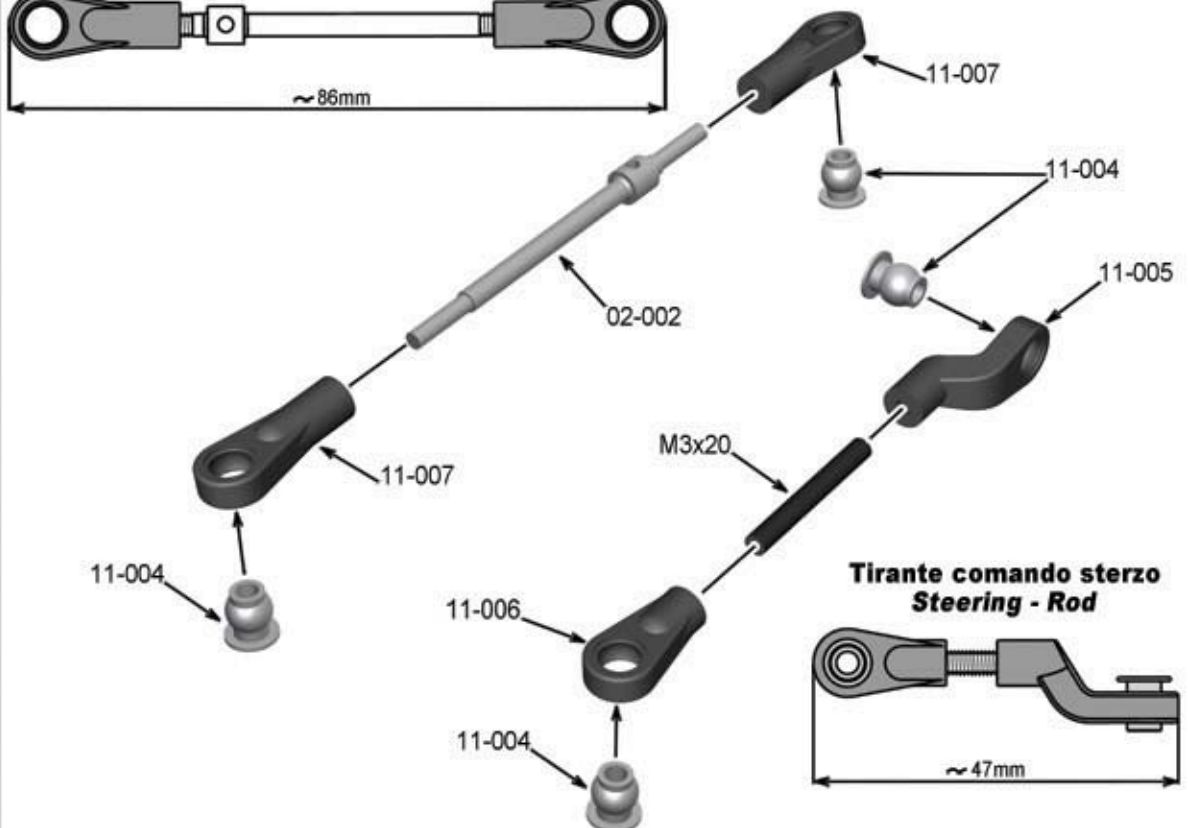
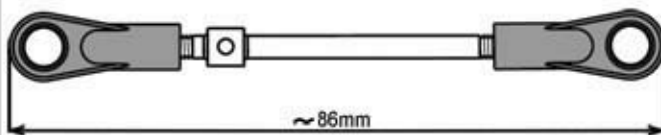

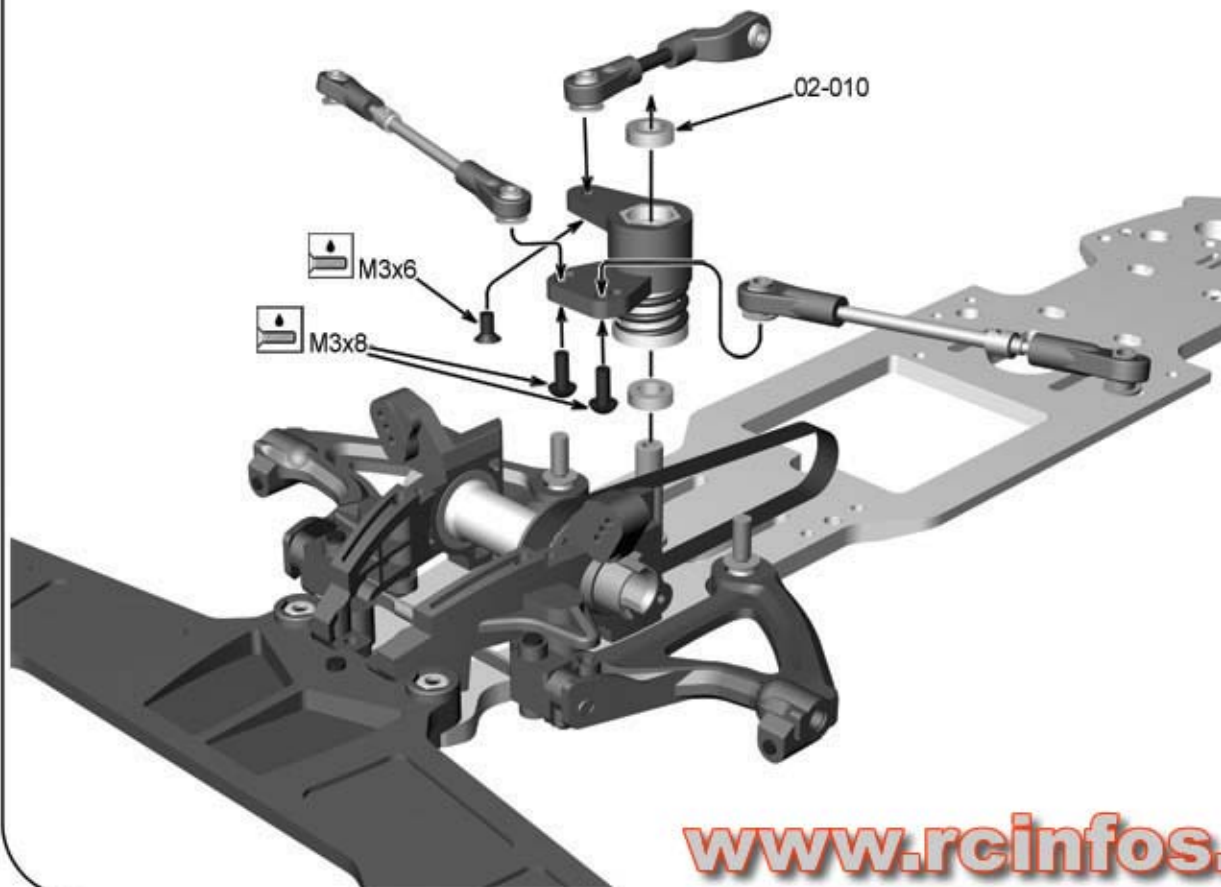
**08****Montaggio Tiranti Sterzo e salva Servo***Tie rod and Servo saver*

Cuscinetto  
Ball Bearing  
Ø6xØ10x3  
02-010\_\_2



14-008  
M3x8\_\_x2



14-001  
M3x6\_\_x1

[www.rcinfos.com](http://www.rcinfos.com)

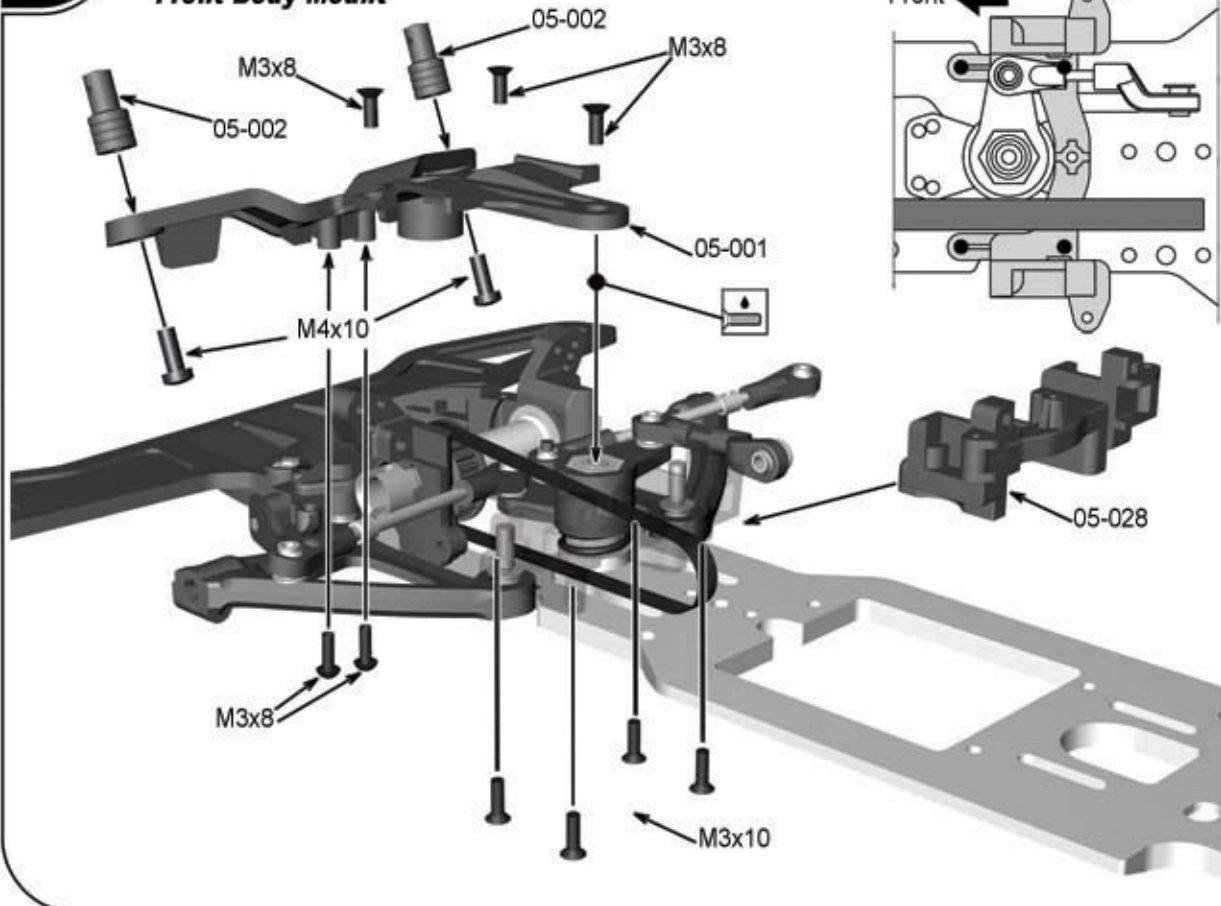
**09****Supporto Carrozzeria Anteriore***Front Body Mount*

14-002  
M3x8\_\_x3



14-003  
M3x10\_\_x4



14-008  
M3x8\_\_x2

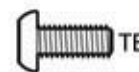



14-015  
M4x10\_\_x2

**Supporto Assale Intermedio**  
*Middle Shaft Bracket*

  
E-Ring Ø4  
14-029 \_\_\_x1

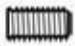
  
TS  
14-003  
M3x10 \_\_\_x4

  
14-025  
M4x8 \_\_\_x1

  
14-023  
M4x4 \_\_\_x2

  
Cuscinetto  
Ball Bearing  
Ø6xØ13x5  
11-015 \_\_\_x2

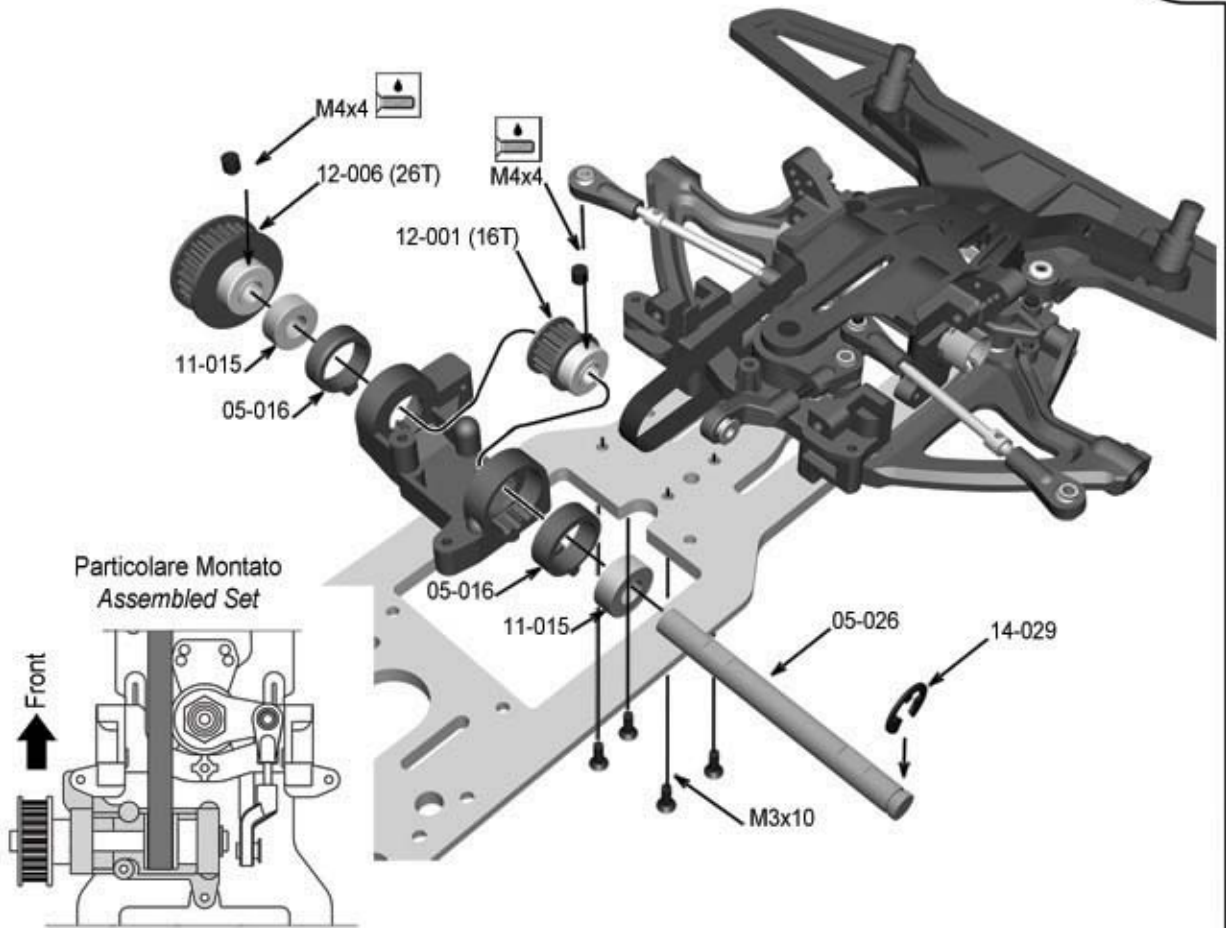

**Regolazione Tensione Cinghia**  
*Belt tensioner*

**Soft**

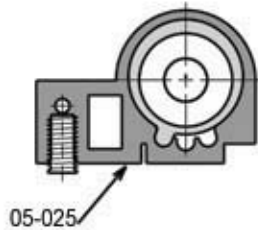

**Neutral**

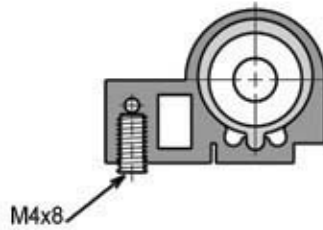

**Hard**

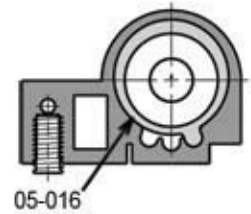

**Pastiglia Freno Dx**  
*Brake Pad Right*



**Pastiglia Freno Sx**  
*Brake Pad Left*



13

**Freno**  
**Brake**

www.rcinfos.com

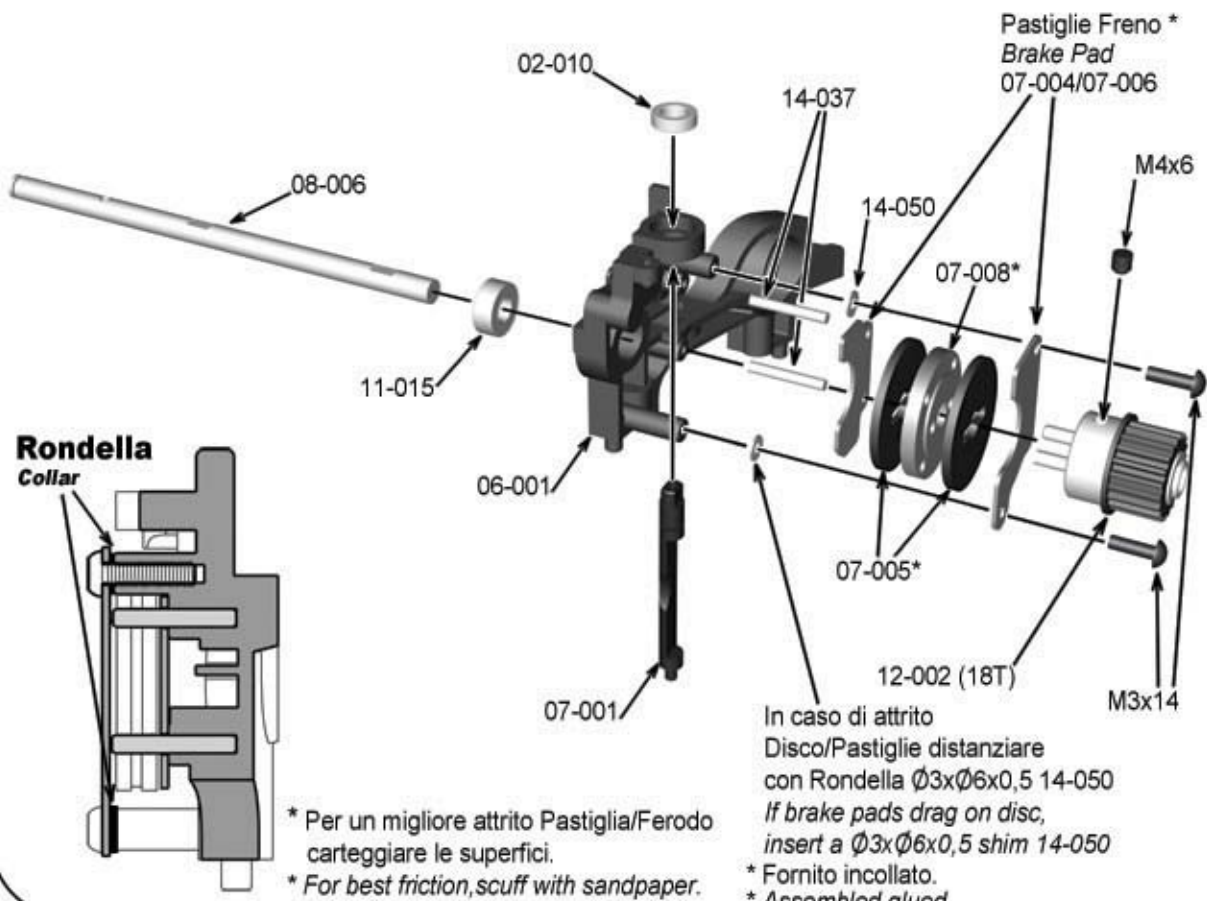



-  Cuscinetto  
Ball Bearing  
 $\varnothing 6 \times \varnothing 10 \times 3$   
02-010\_\_x1
-  Cuscinetto  
Ball Bearing  
 $\varnothing 6 \times \varnothing 13 \times 5$   
11-015\_\_x1
-  14-023  
M4x6\_\_x1
-  TB  
14-013  
M3x14\_\_x2
-  14-037  
 $\varnothing 2,5 \times 15,8$ \_x1

14a

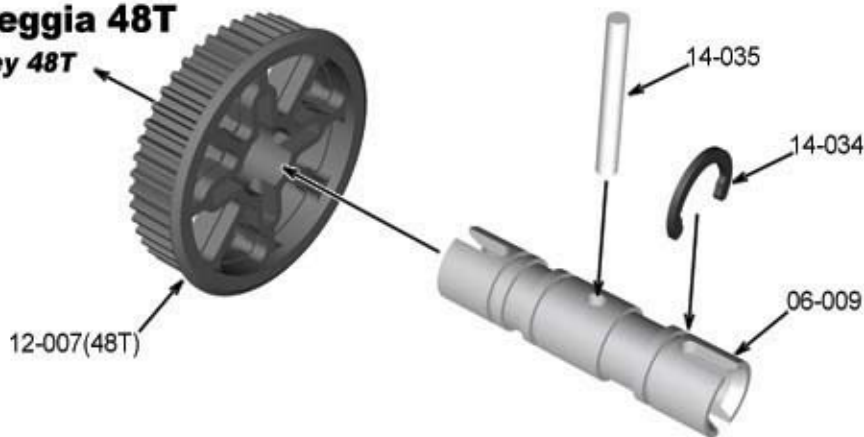
**Puleggia 48T**  
**Pulley 48T**



-  C-Ring  $\varnothing 12$   
14-034\_\_x1
-  14-023  
M4x4\_\_x3

14b

**Barra Antirollio Post.**  
**Rear Anti-Roll Bar**

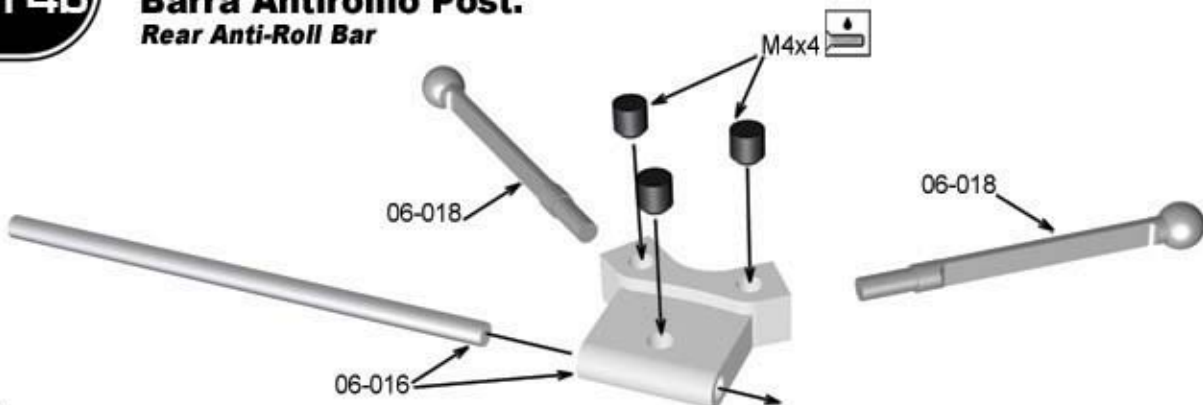

-  14-035  
 $\varnothing 3 \times 25$ \_x1





Cuscinetto  
Ball Bearing  
Ø6xØ13x5  
11-015\_\_x1



Cuscinetto  
Ball Bearing  
Ø12xØ18  
11-010\_\_x2



Cuscinetto  
Ball Bearing  
Ø3xØ8x3  
06-010\_\_x2



TS  
14-002  
M3x8\_\_x3



14-023  
M4x4\_\_x1

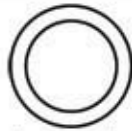

Rasamento  
Washer  
Ø12xØ16x0,5  
14-044\_\_x1

## Spalline Posteriori

### Rear Bulkheads

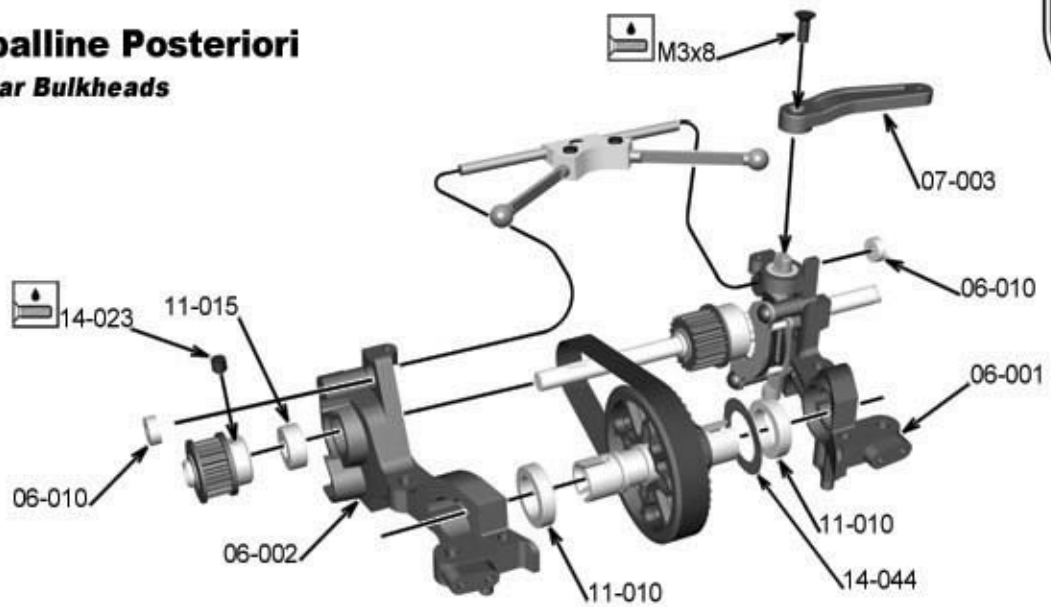

15a

## Montaggio del Centraggio supporto carrozzeria post.

### Assembly of Rear Body Centring Support



15b

[www.rcinfos.com](http://www.rcinfos.com)



TB  
14-008  
M3x8\_\_x2



TS  
14-004  
M3x14\_\_x2



14-018  
M3x3\_\_x2



Collarino  
Collar  
06-034\_\_x2

## Unione spalline Post.

### Rear Bulkheads Joining

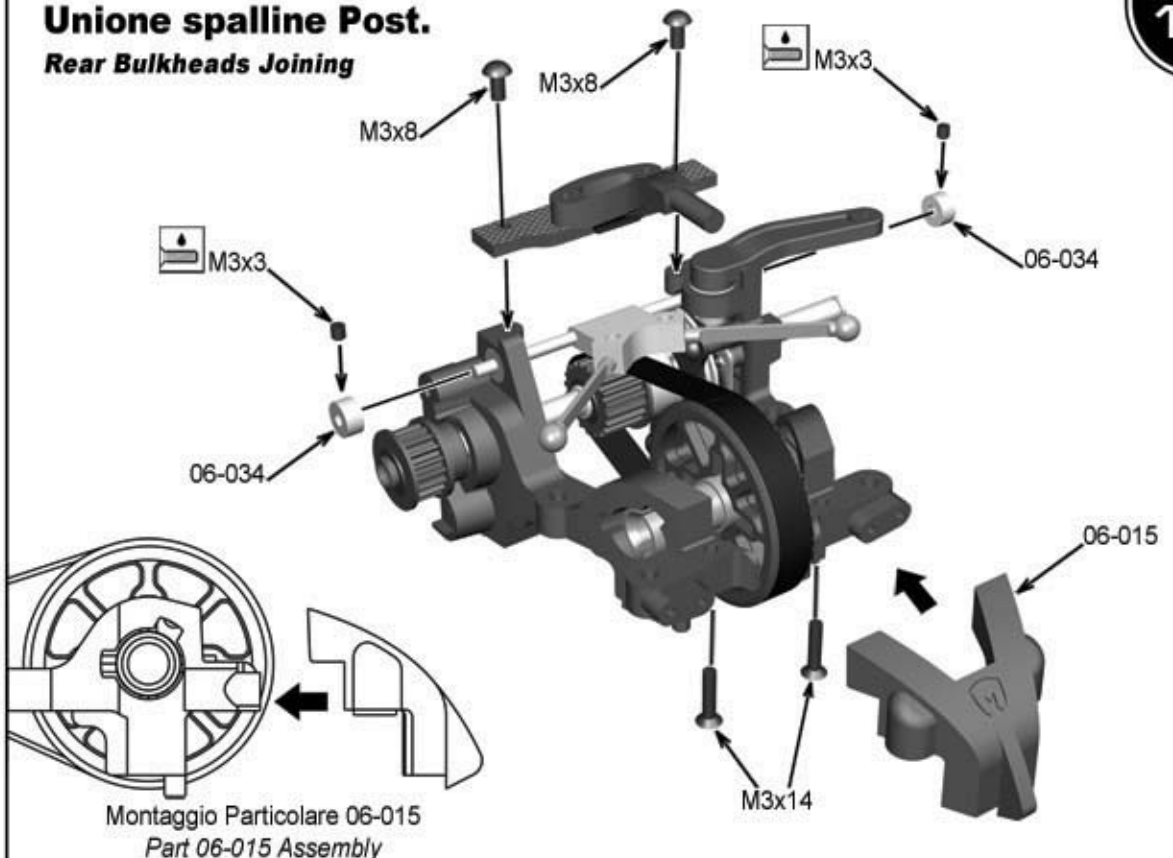

16

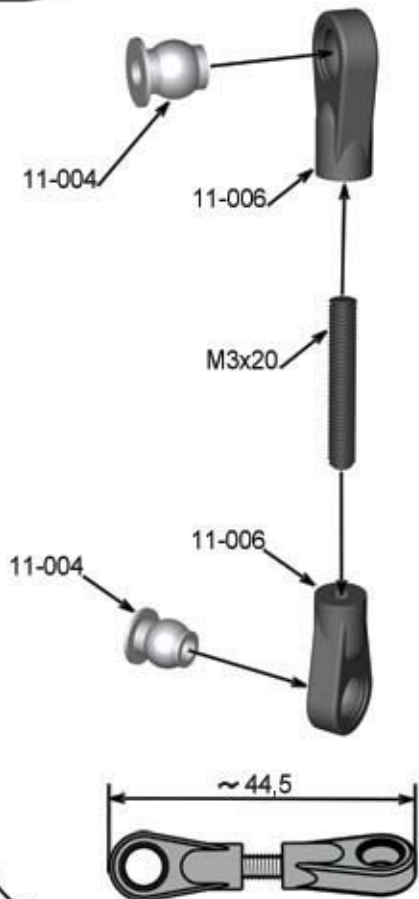
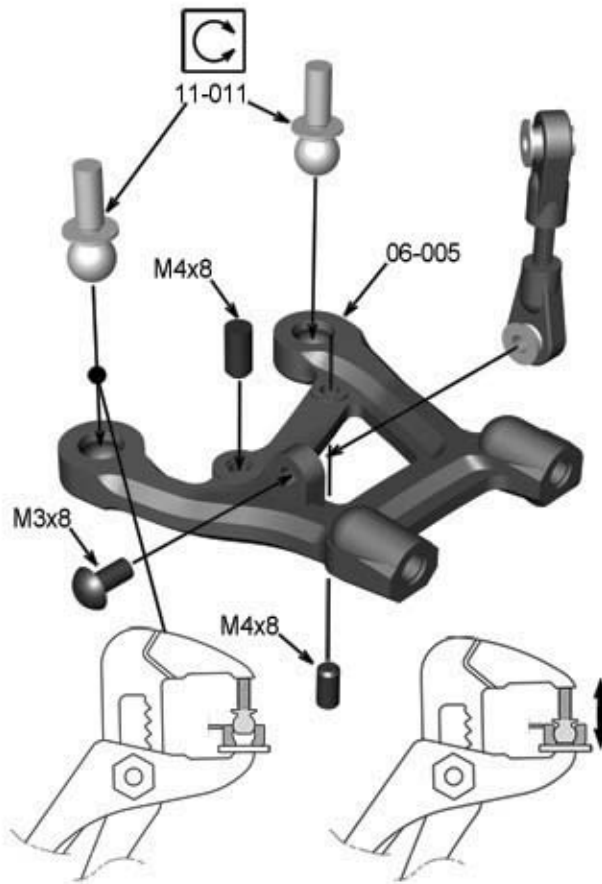
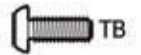
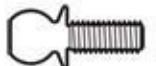
**17****Tirante Barra A/R post. X2**  
*Rear stabilizer bar Linkage***18****Braccetto post. Inferiore Dx/Sx**  
*Rear Lower Arm*14-022  
M3x20 \_\_\_x214-025  
M4x8 \_\_\_x2TB  
14-008  
M3x8 \_\_\_x411-011  
M4 \_\_\_x4

11-004 \_\_\_x2

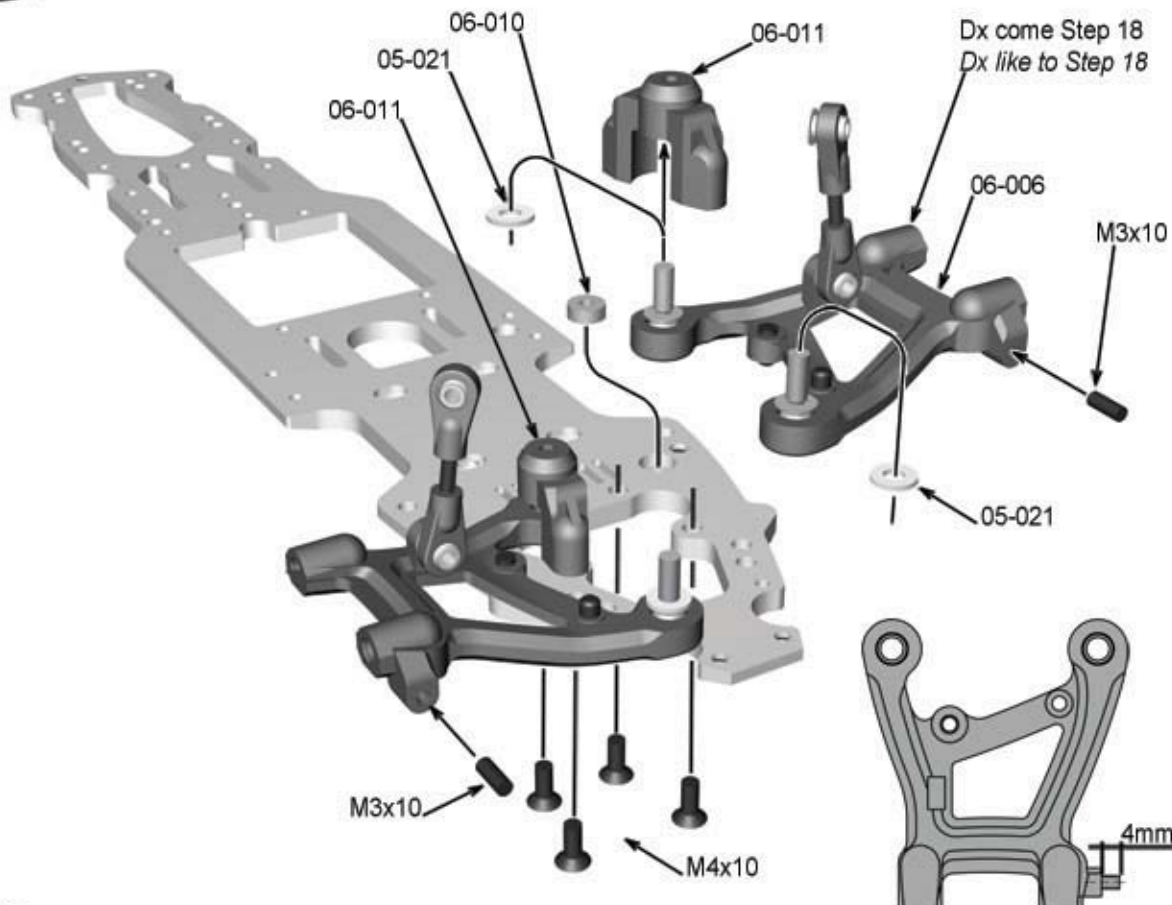
**19****Pre-montaggio Braccetti post.**  
*Rear Arms Pre-Assembly*14-020  
M3x10 \_\_\_x2Cuscinetto  
Ball Bearing  
Ø3xØ8  
06-010 \_\_\_x1TS  
14-005  
M4x10 \_\_\_x405-021  
Ø4xØ8x1 \_\_\_x4

**Installazione Retrotreno**  
*Rear Axle Assembly*

TB  
14-008  
M3x8 x4

TS  
14-005  
M4x10 x4

TS  
14-003  
M3x10 x6

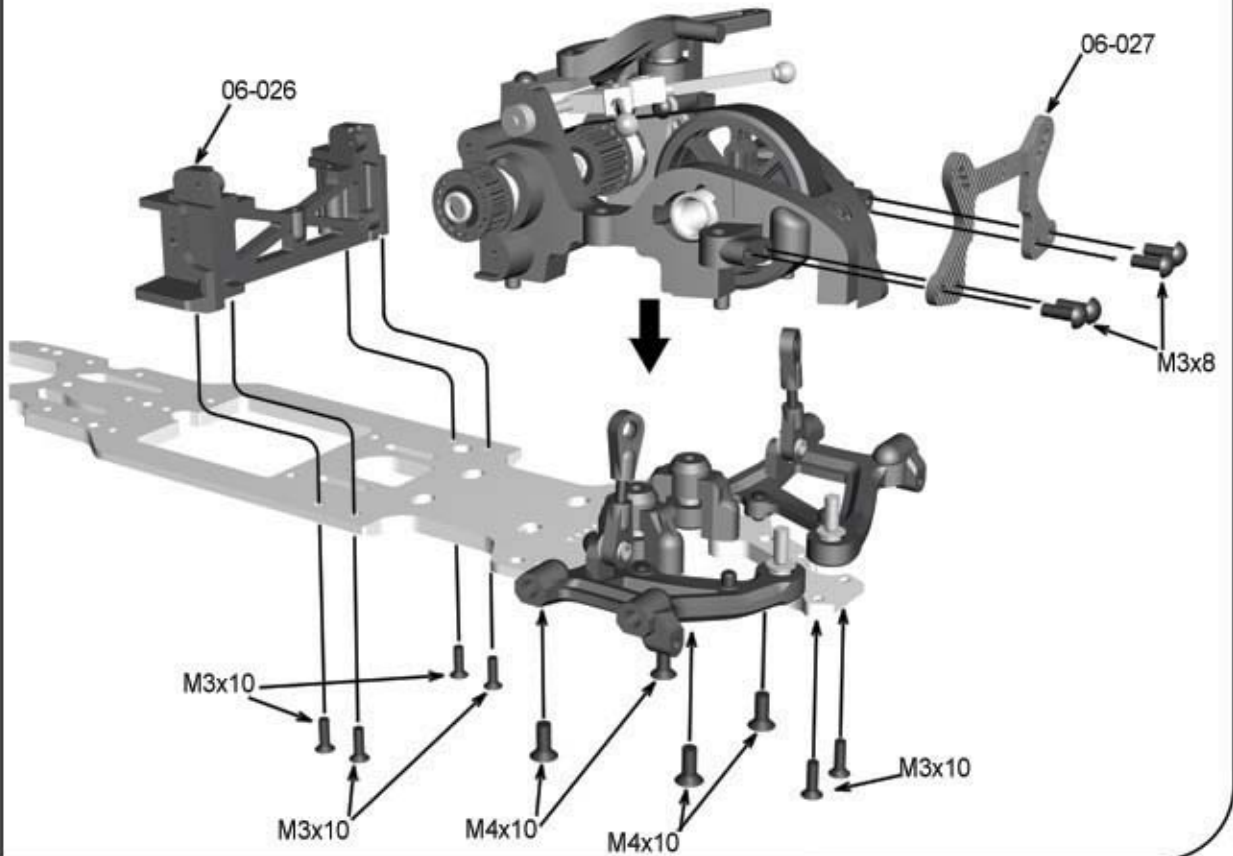

**Installazione Braccetti Anteriori Superiori**  
*Front Upper Arms Assembly*

M4  
11-011  
M4 x4

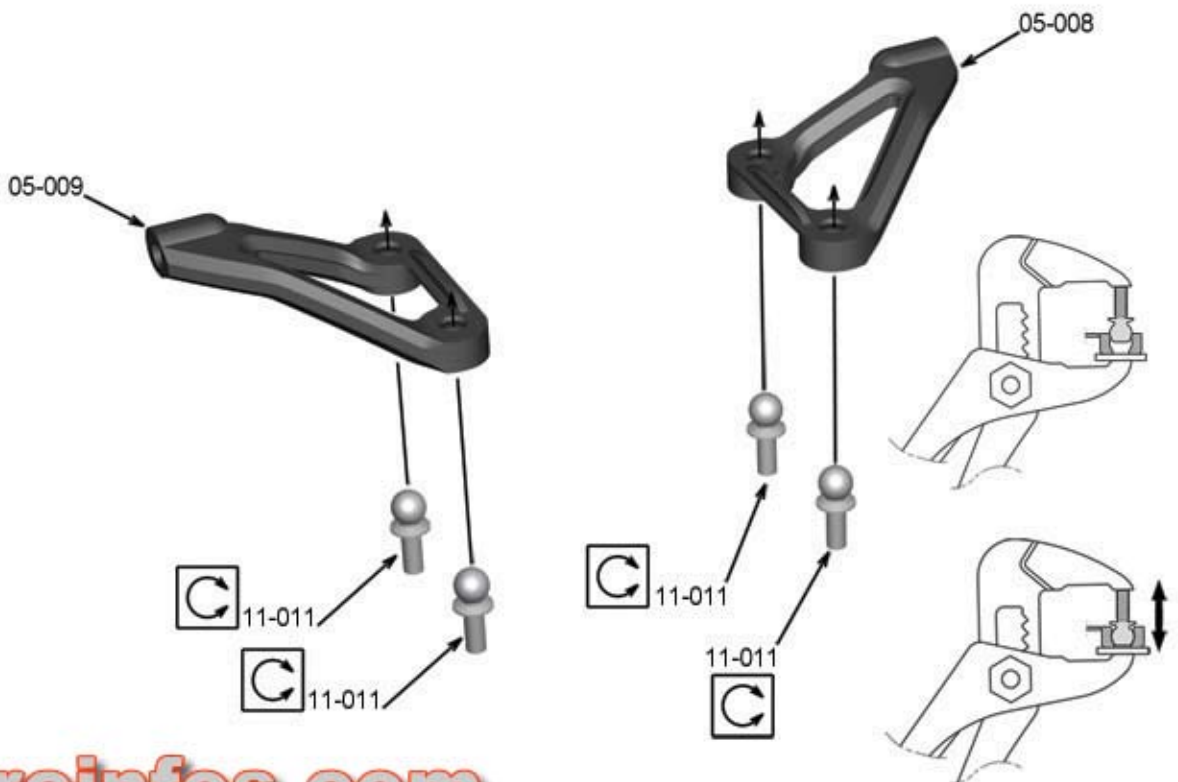

**Installazione Braccetti Posteriori Superiori**  
*Rear Upper Arms Assembly*

www.rcinfos.com

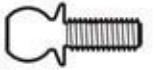
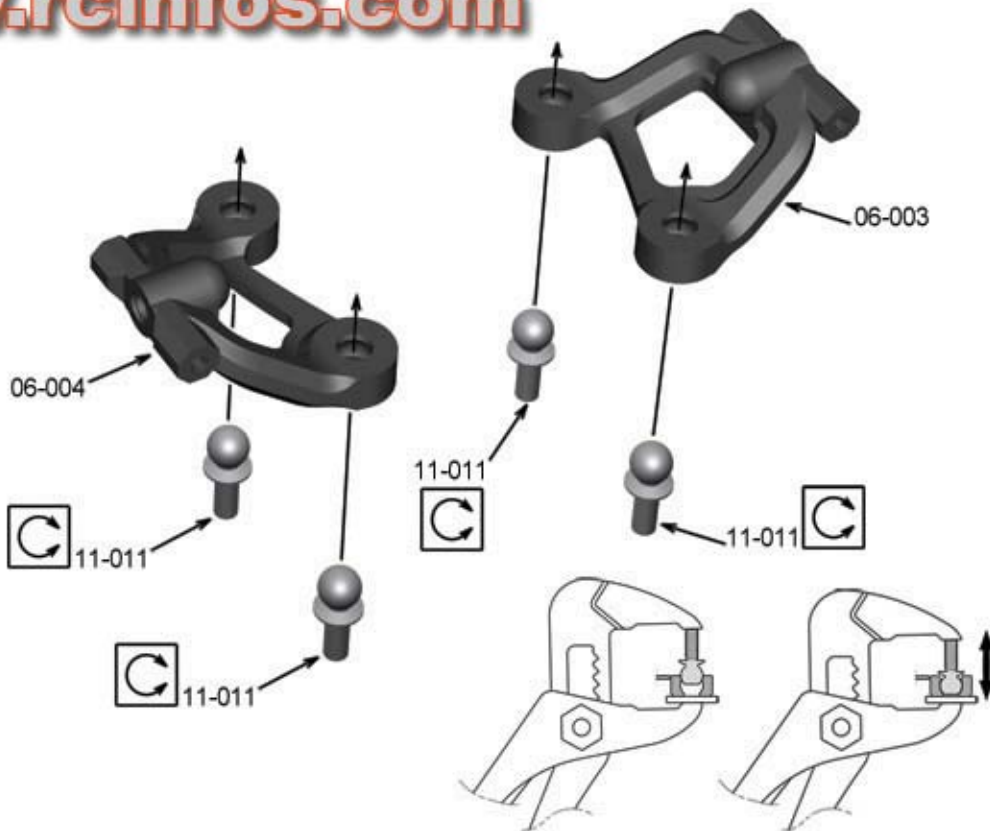

11-011  
 M4 \_\_\_\_x4

**Braccetti post. sup. / Rollbar**  
*Rear Upper Arms / Rollbar*

Da inserire dopo il montaggio del particolare 06-003/06-004.  
 To insert after installation of the part n°06-003/06-004.

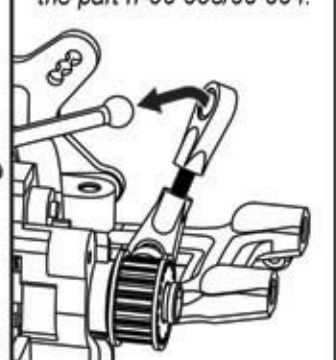
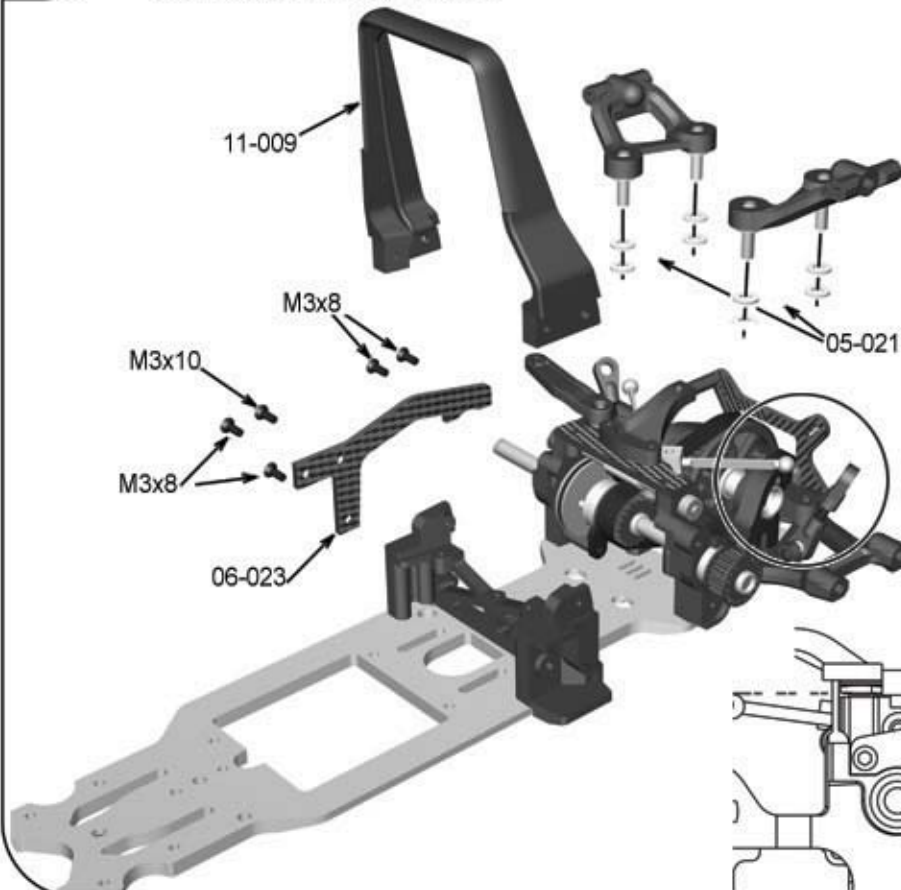

TS  
 14-002  
 M3x8 \_\_\_\_x4

TS  
 14-003  
 M3x10 \_\_\_\_x1

05-021  
 Ø4xØ8x1 \_\_\_\_x8

Montaggio particolare 06-023  
 Part 06-023 Assembly



14-001

M3x6 \_\_\_x6



14-012

M3x12 \_\_\_x2



14-019

M3x5 \_\_\_x2

## Corone Cambio Gears

24

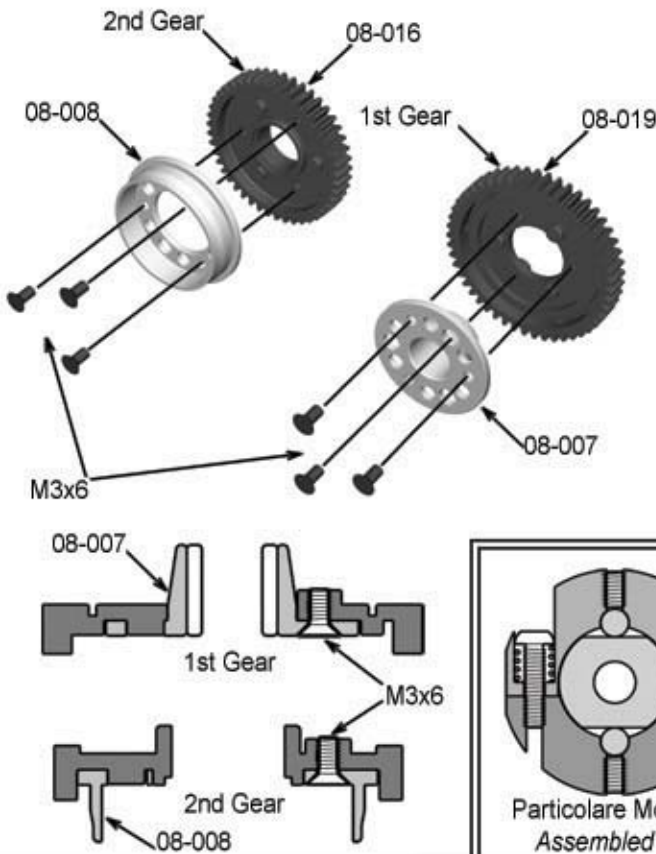

## Cambio 2 Speed Assembly

25

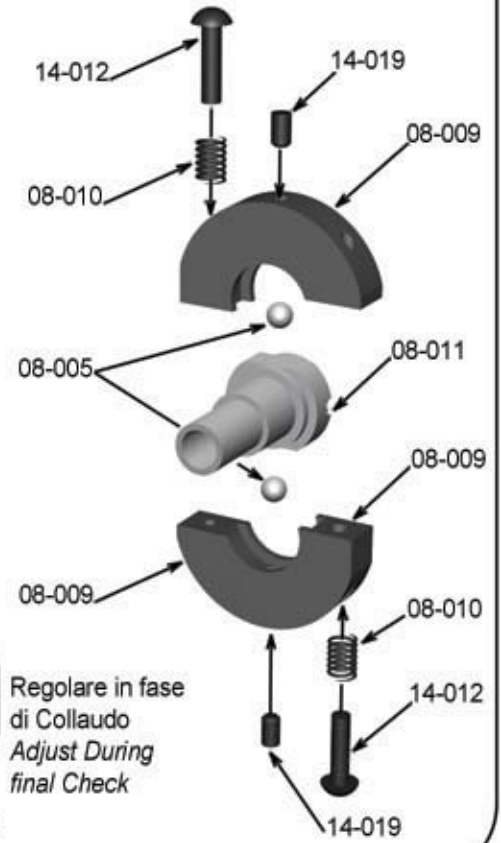

## Assemblaggio Cambio Gears Assembly

26



14-032

Ø2,5x12 \_\_\_x1



Cuscinetto Flangiato

Ball Bearing

Ø10xØ15x4

08-002 \_\_\_x2



E-Ring Ø5

14-030 \_\_\_x1

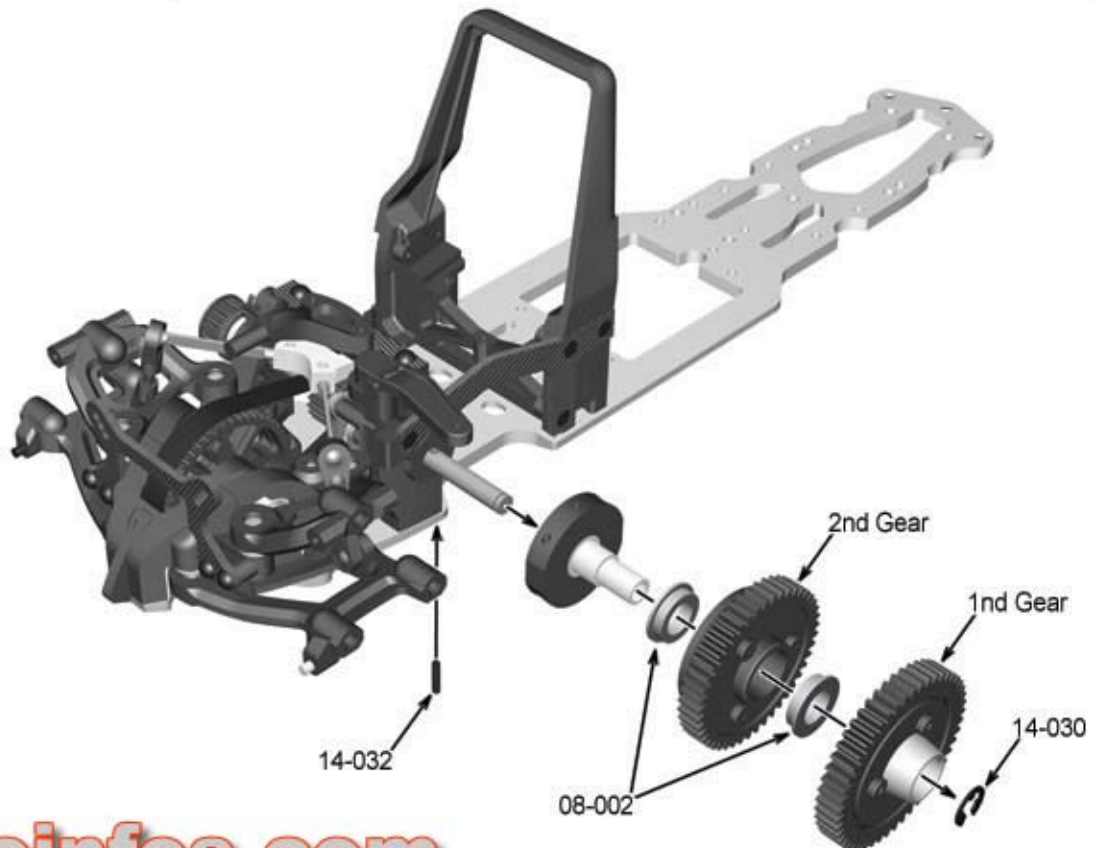

27

**Braccetti Anteriori Superiori**  
*Front Suspension Upper Arms*

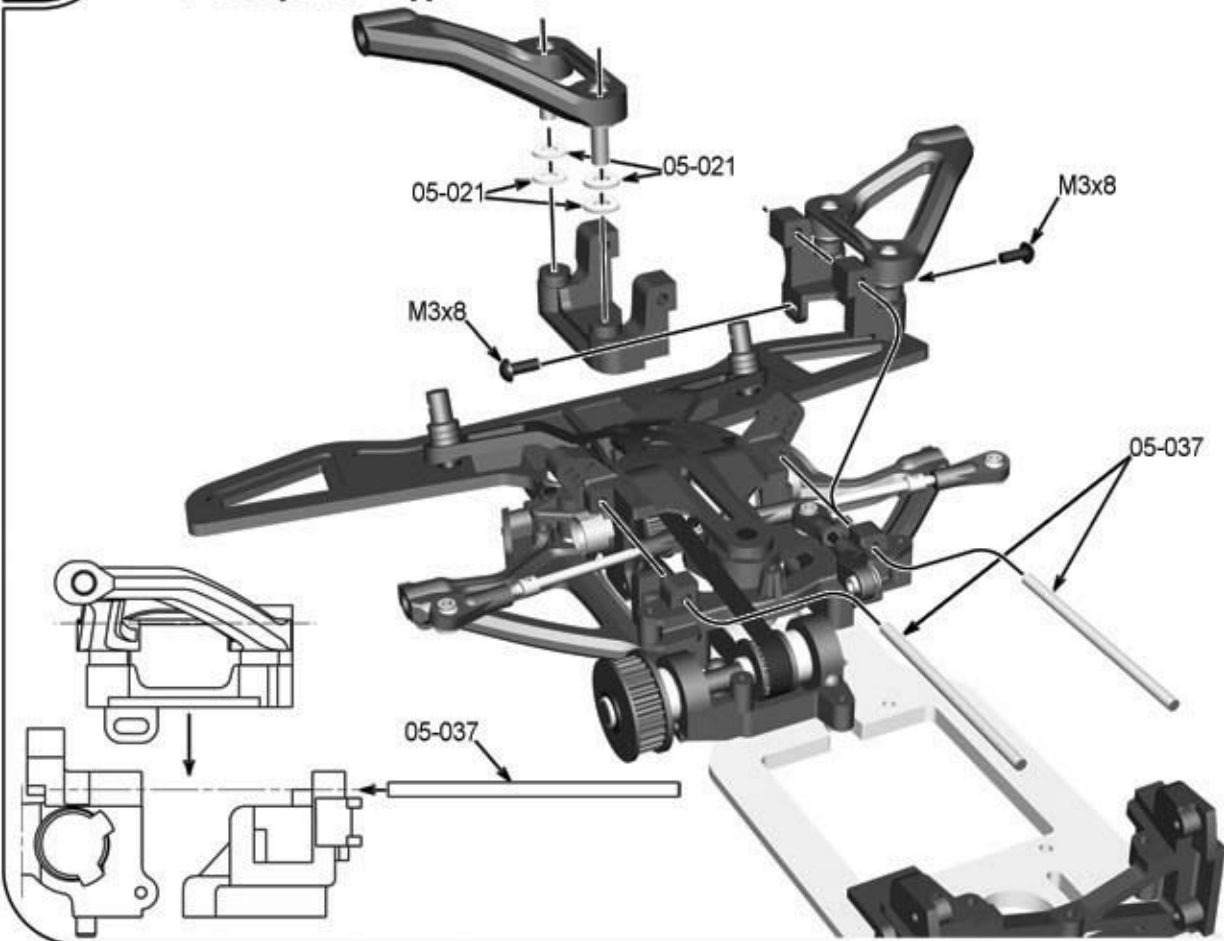

TB  
14-008  
M3x8 \_\_\_x2



05-021  
Ø4xØ8x1 \_\_\_x8

28

**Distanziali regolazione Caster**  
*Washers for Caster adjustment*

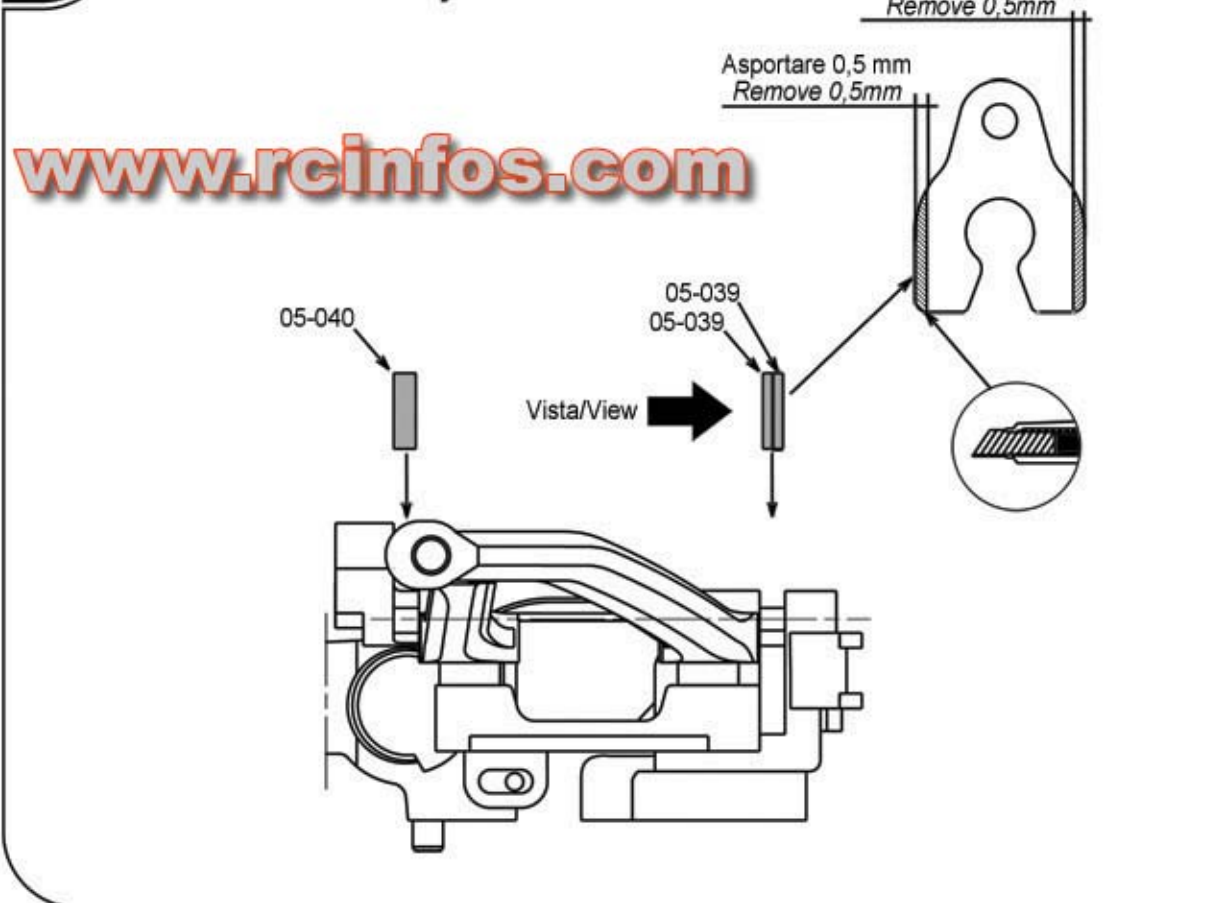

[www.rcinfos.com](http://www.rcinfos.com)



05-039\_x4



05-040\_x2

**Porta Mozzo Posteriore x2**  
**Rear Hub**

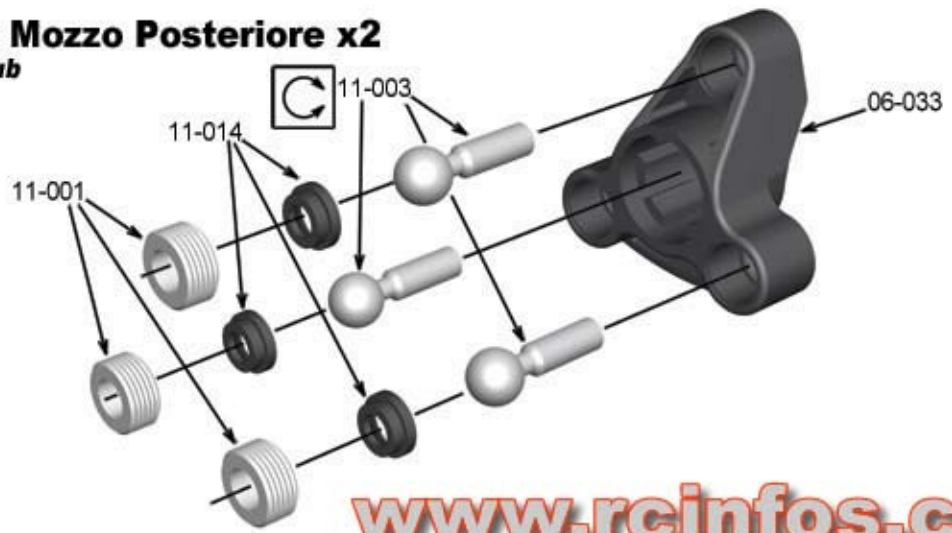

[www.rcinfos.com](http://www.rcinfos.com)

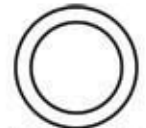

Rasamento  
Washer  
Ø12xØ16x0,4  
14-043 \_\_\_x1



Cuscinetto  
Ball Bearing  
Ø12xØ18x4  
11-010 \_\_\_x2



14-034  
Ø3x24 \_\_\_x1



11-003 \_\_\_x3

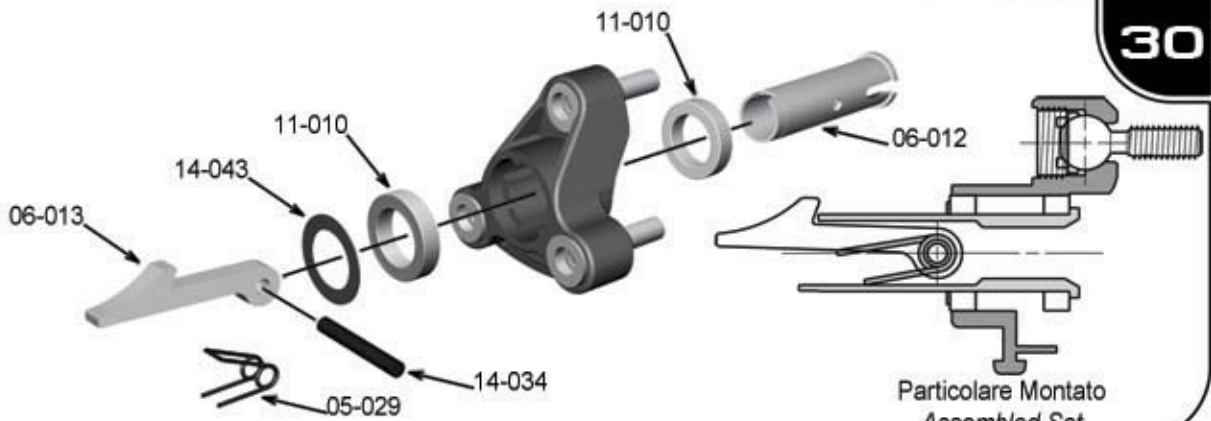

Particolare Montato  
Assembled Set



Rasamento  
Washer  
Ø12xØ16x0,4  
14-043 \_\_\_x1



14-034  
Ø3x24 \_\_\_x1



Cuscinetto  
Ball Bearing  
Ø12xØ18x4  
11-010 \_\_\_x2



11-002 \_\_\_x2

**Porta Mozzo Anteriore x2**  
**Front Hub**

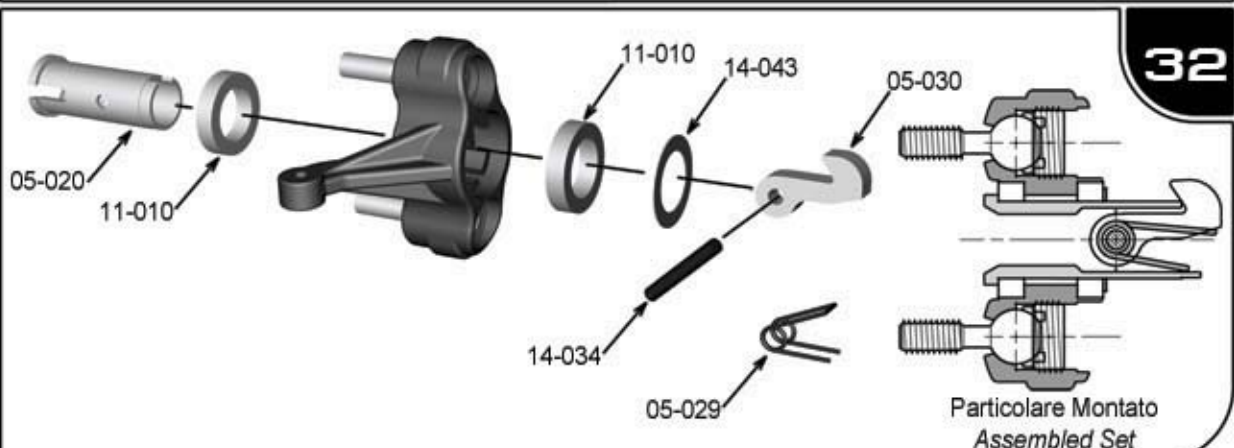
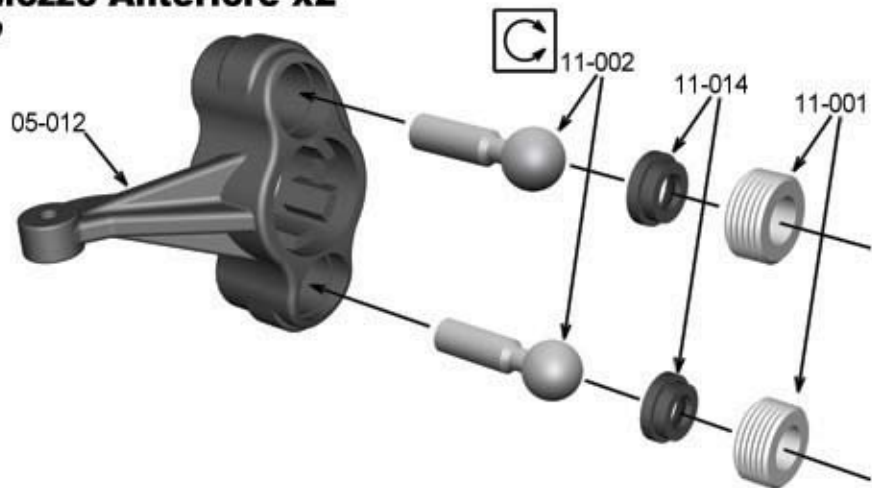

Particolare Montato  
Assembled Set

**33**

### Assemblaggio Portamozzi Anteriore

Front Wheel-Hub Holders Assembly

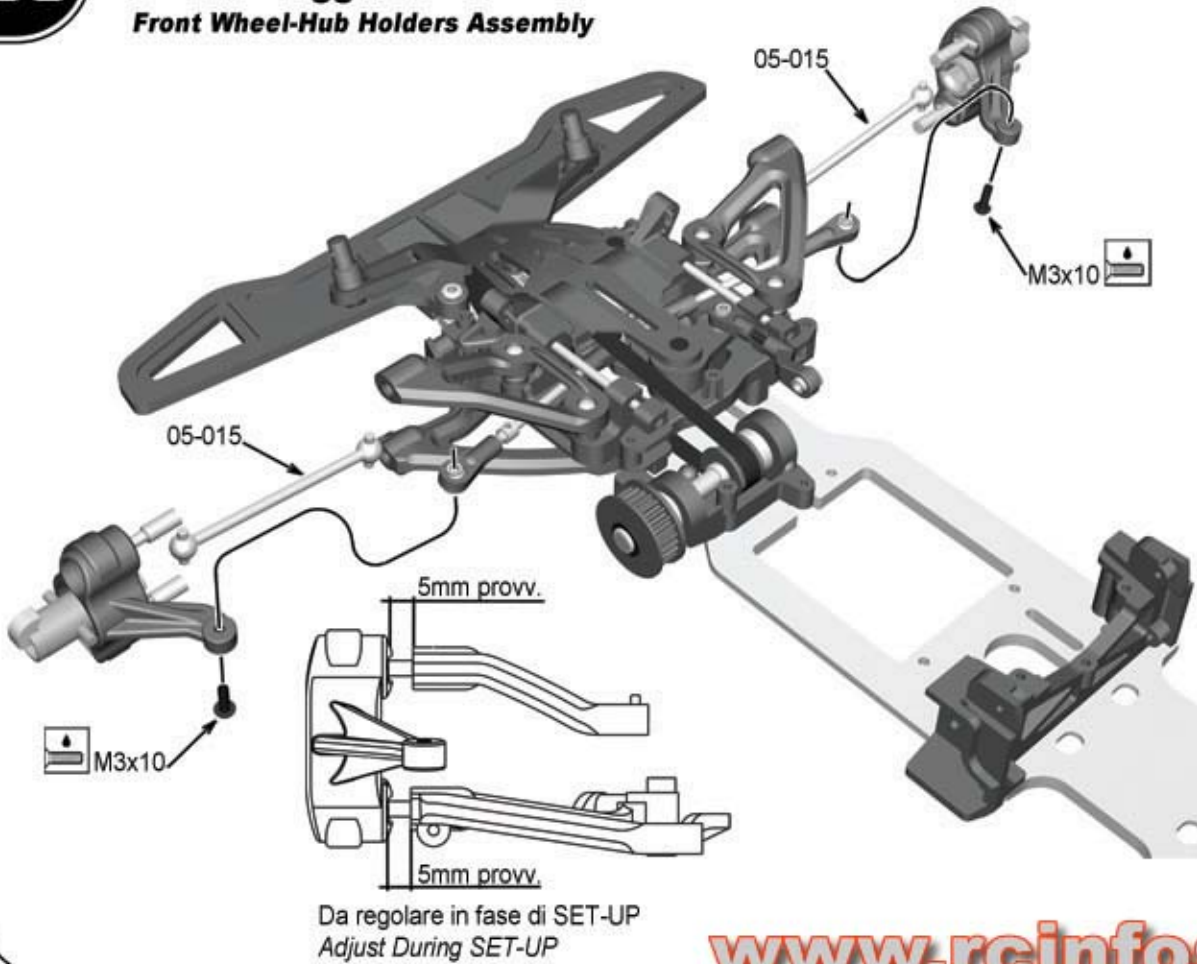

TB  
14-011  
M3x10\_\_x2

**34**

### Supporto Carrozzeria Posteriore

Rear Body Support

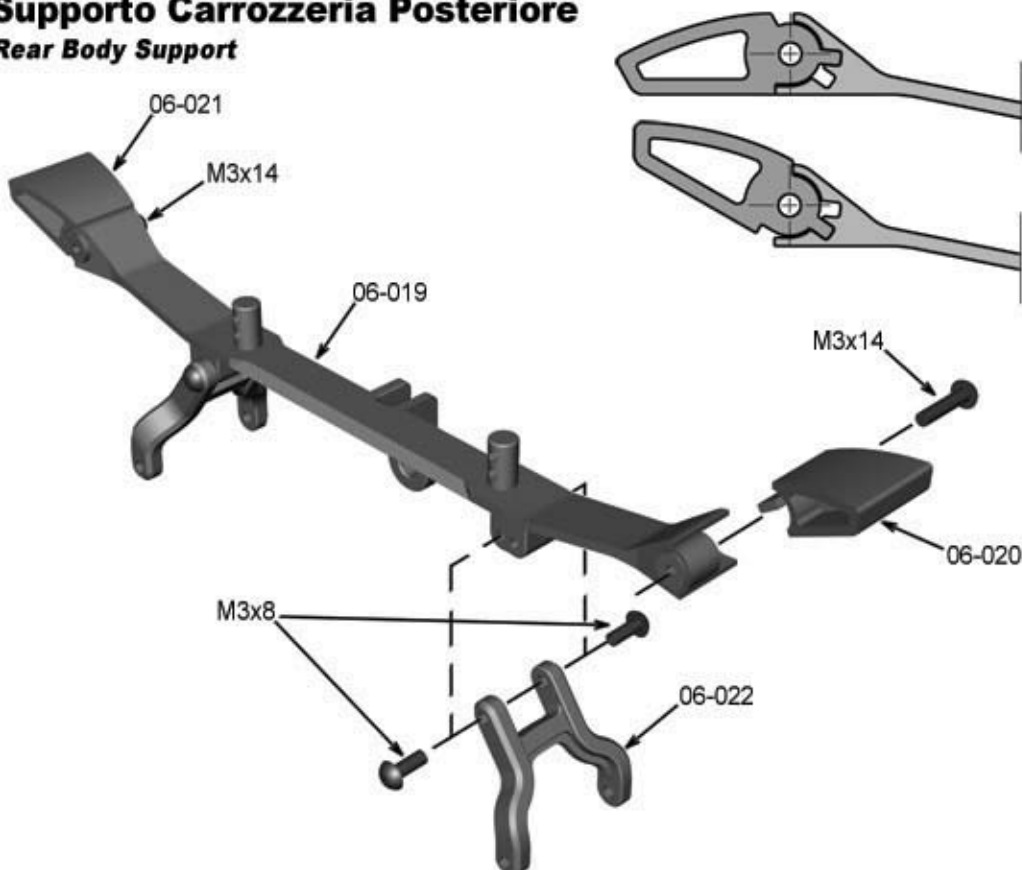

TB  
14-008  
M3x8\_\_x4

TB  
14-013  
M3x14\_\_x2



**Assemblaggio Portamozzi Posteriore**  
*Rear Wheel-Hub Holders Assembly*

TB  
 14-011  
 M3x10 \_\_\_x4

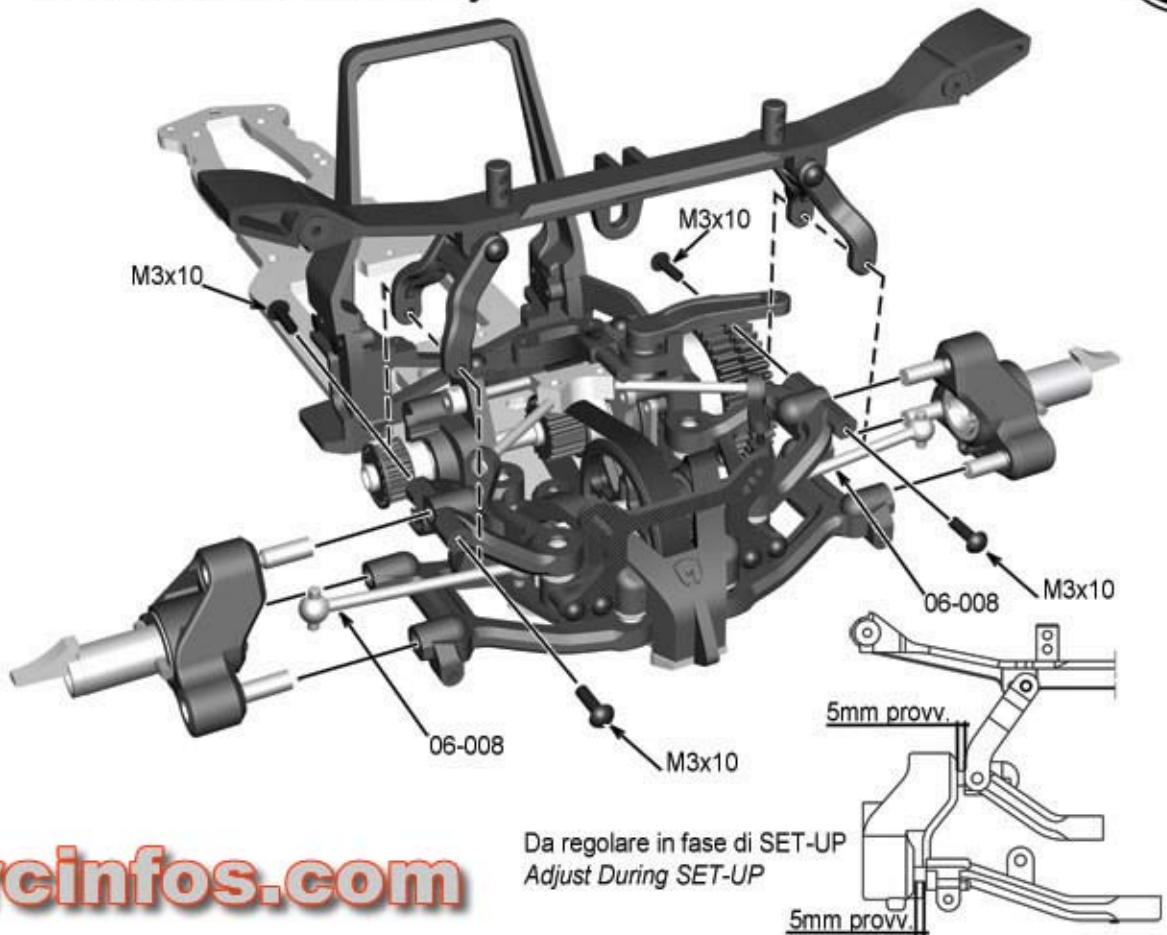

[www.rcinfos.com](http://www.rcinfos.com)

**Assemblaggio Servocomandi**  
*Servo Mount Assembly*

TB  
 14-012  
 M3x12 \_\_\_x4

TB  
 14-013  
 M3x14 \_\_\_x4

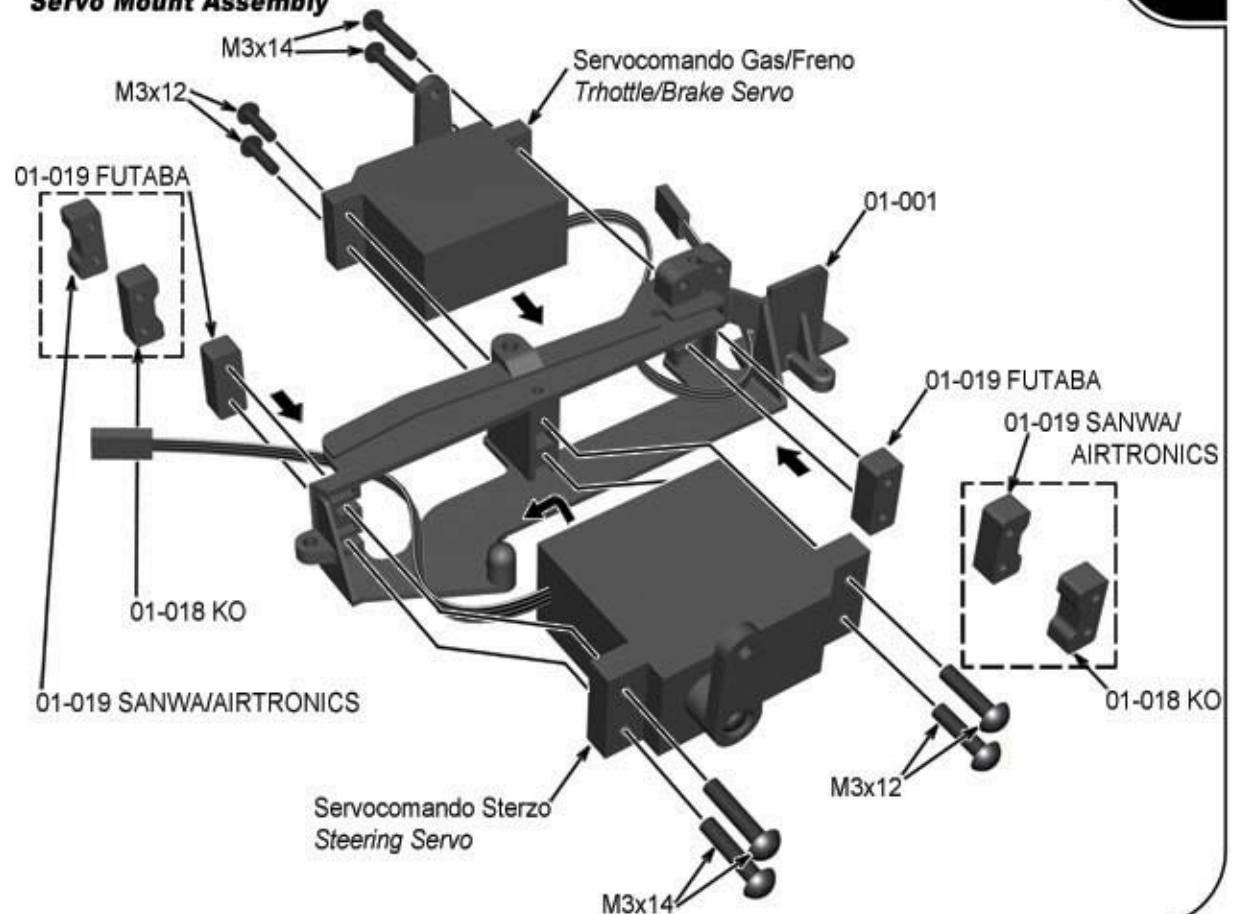

**37**

## Montaggio Ricevente Receiver Assembly

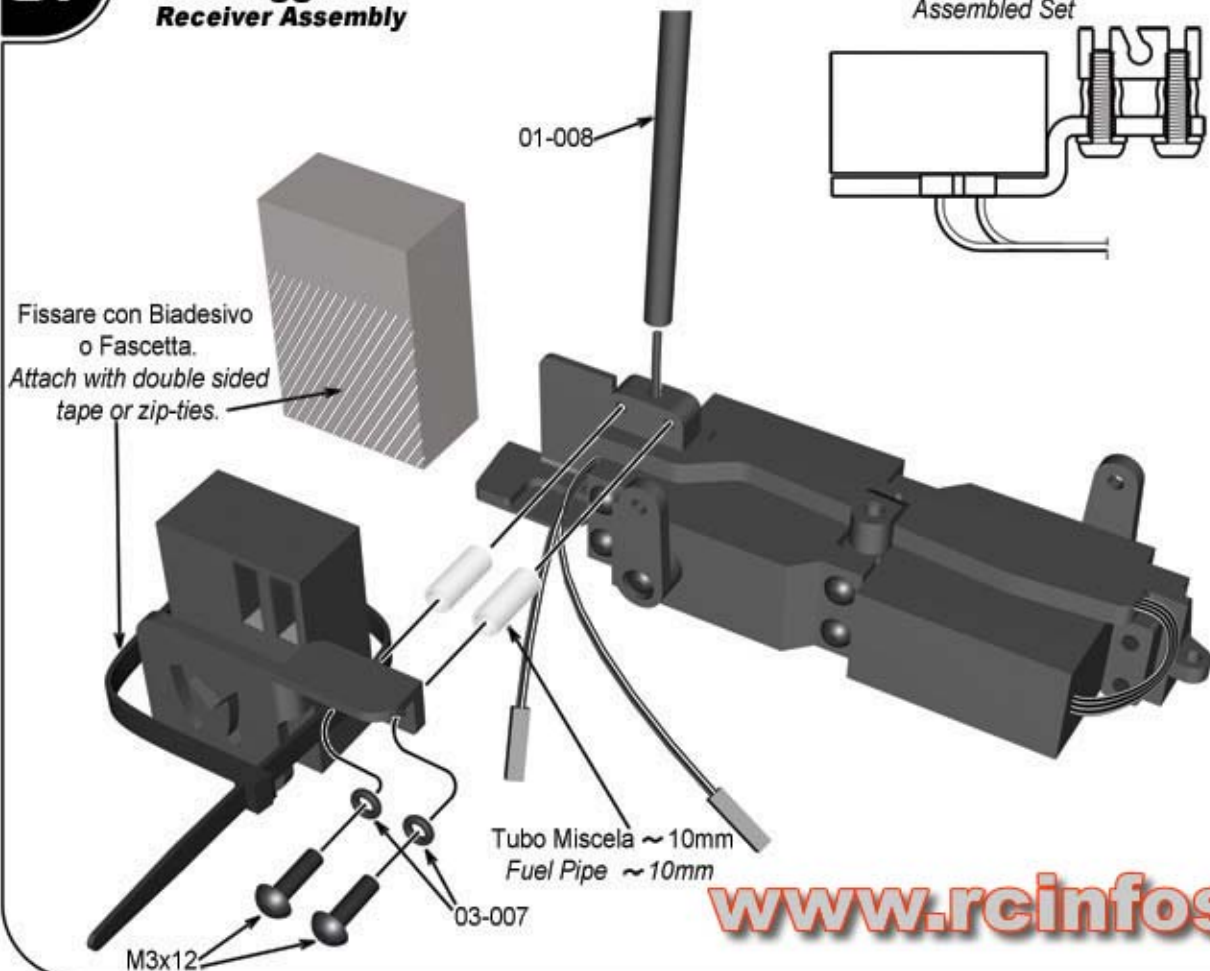

14-011  
M3x12\_\_x2



O-Ring Ø6  
03-007\_\_x2

[www.rcinfos.com](http://www.rcinfos.com)

**38**

## Assemblaggio Impianto Radio Installation of Radio Tray

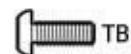
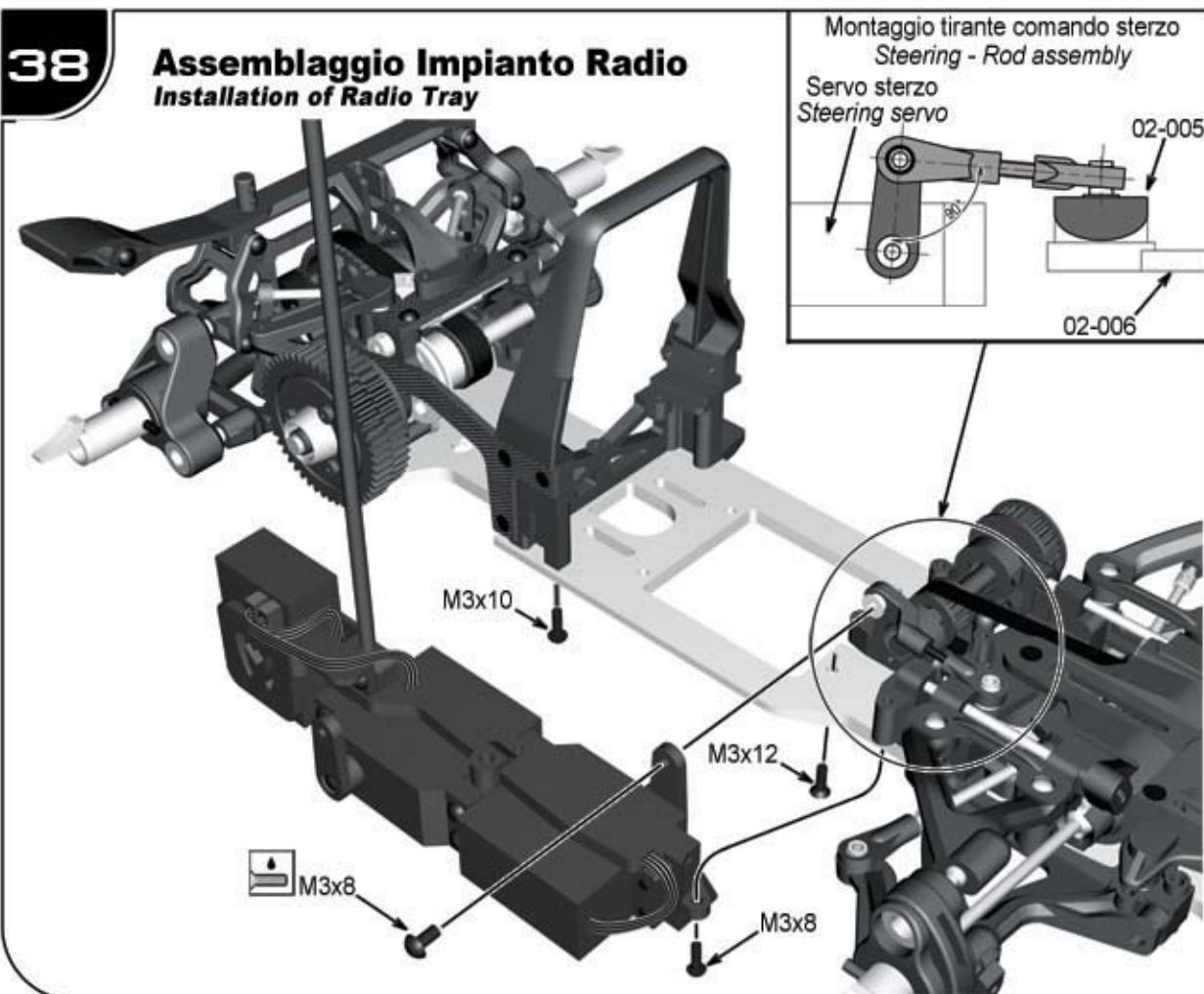

14-008  
M3x8\_\_x2



14-011  
M3x10\_\_x1



14-003  
M3x10\_\_x1

**Installazione Batteria**  
**Battery Assembly**

Fissare con Nastro Adesivo  
*Fix by Sticky tape*

Batteria AAA  
AAA Battery

TS  
14-002  
M3x8 \_\_\_x3

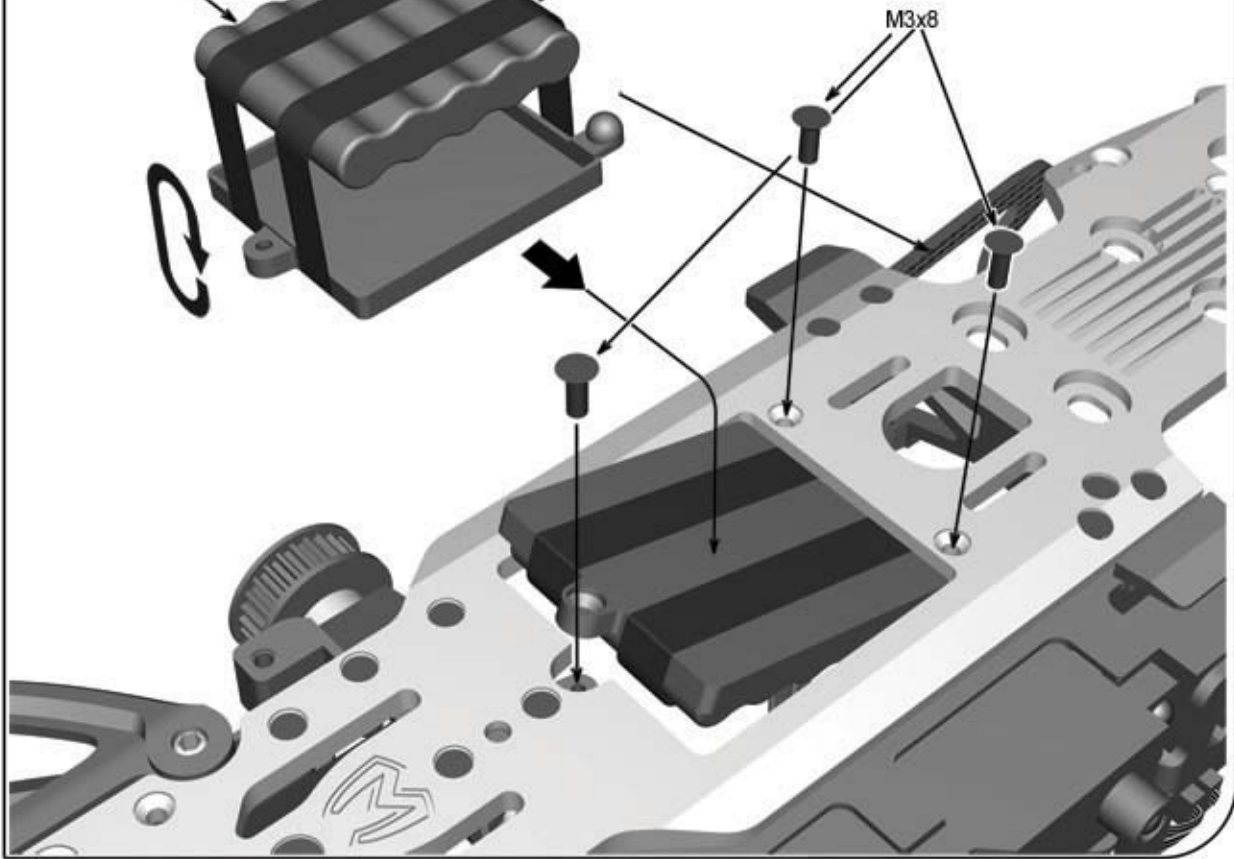

**Serbatoio**  
**Fuel Tank**

[www.rcinfos.com](http://www.rcinfos.com)

E-Ring Ø1,9  
14-026 \_\_\_x2

TB  
14-007  
M3x6 \_\_\_x1

O-Ring  
Ø16x3  
03-011 \_\_\_x1

03-004 \_\_\_x4

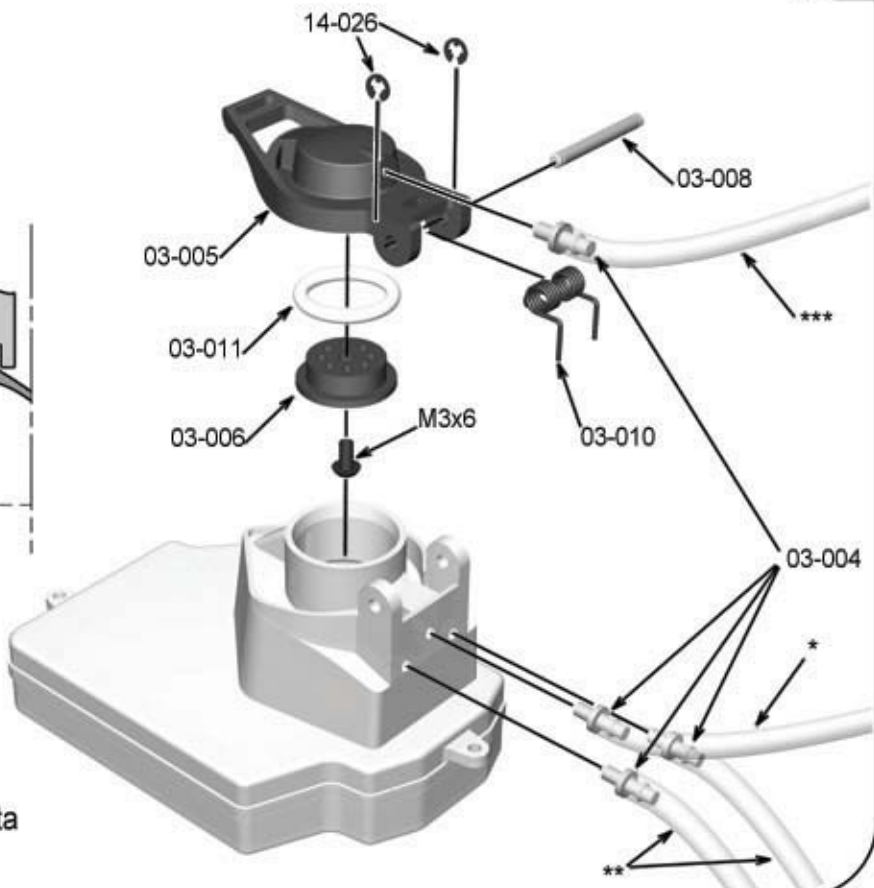
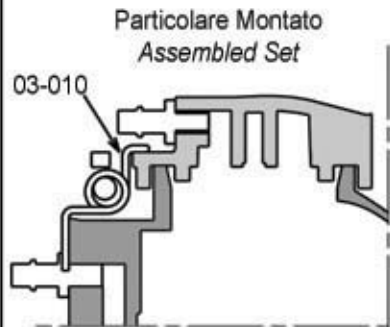

- \* Tubo collegamento Serbatoio/Motore  
*Fuel Tank/Engine pipe*
- \*\* Tubo sfogo miscela  
*Fuel drain pipe*
- \*\*\* Tubo Serbatoio/Marmitta  
*Fuel Tank/Muffler pipe*

**41**

## Installazione Serbatoio

### Fuel Tank Assembly

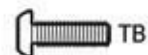
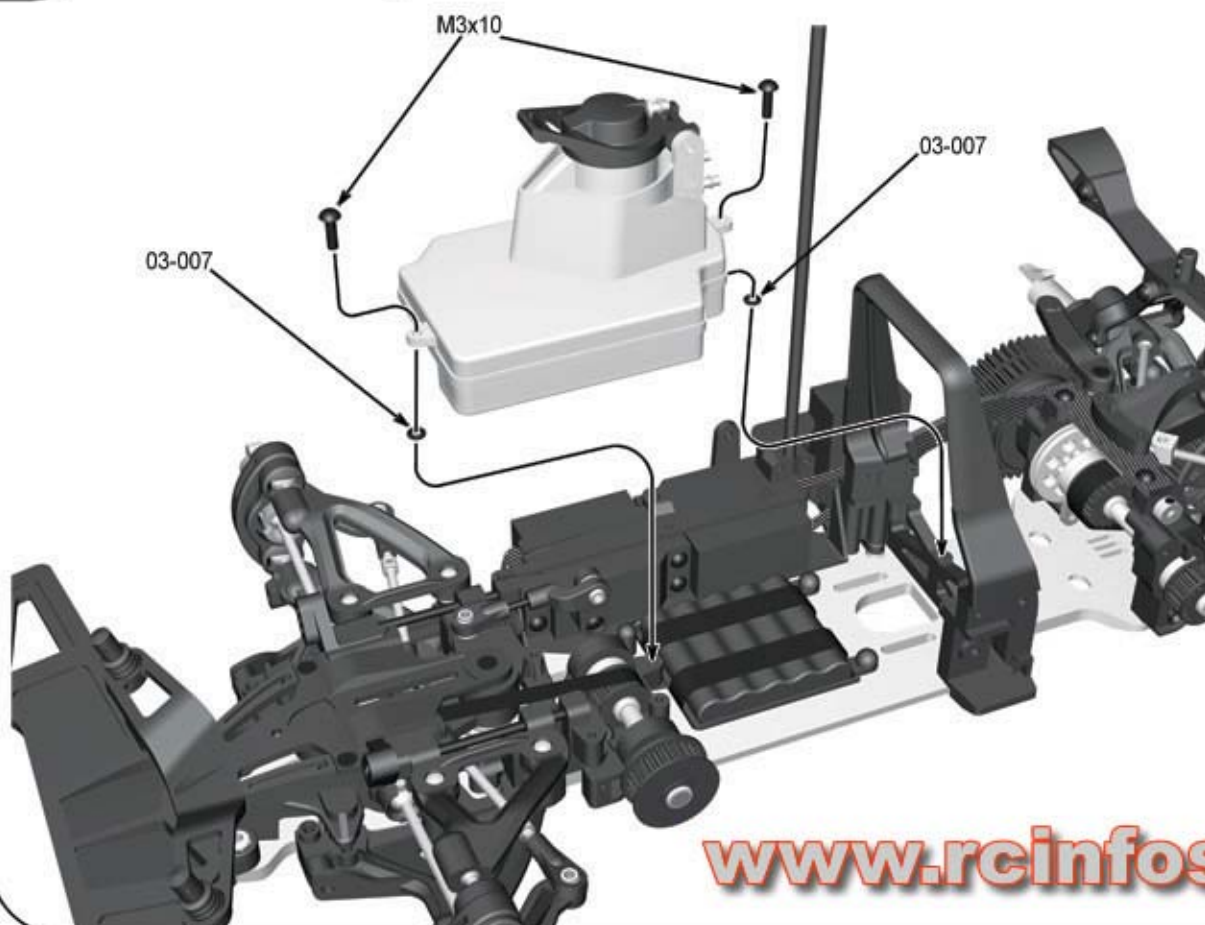

14-011  
M3x10 \_\_\_x2



O-Ring Ø6  
03-007 \_\_\_x2

[www.rcinfos.com](http://www.rcinfos.com)

**42**

## Fissaggio Piastra Superiore

### Upper Plate Fixing

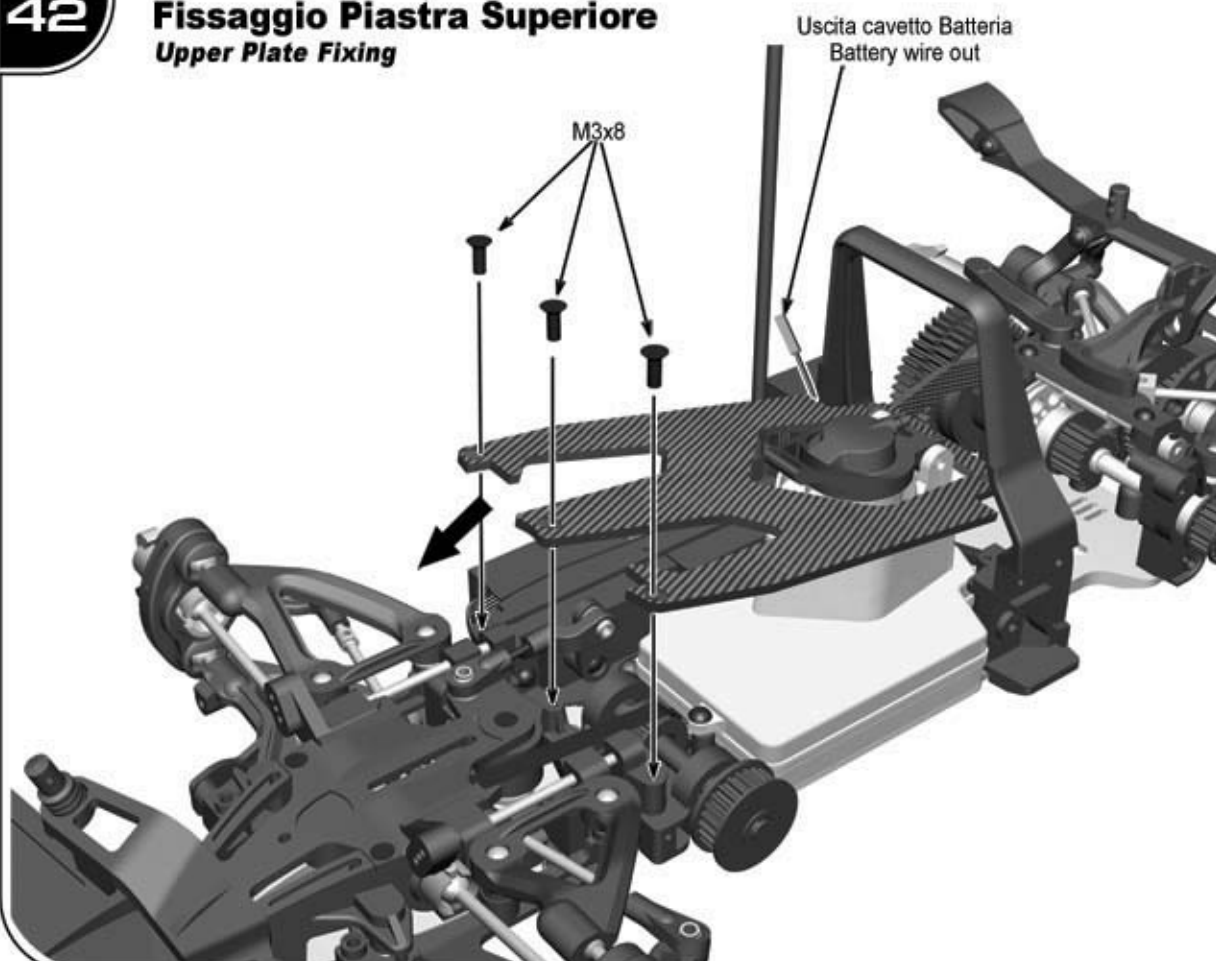

14-002  
M3x8 \_\_\_x3

### Assemblaggio Tiranteria Tie-Rods Assembly



14-011  
M3x10 x1

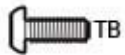

14-008  
M3x8 x1



14-018  
M3x3 x3

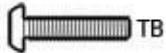

14-013  
M3x14 x1



14-022  
M3x20 x1



Rondella  
Washer  
14-049  
Ø3xØ8Ø0,5\_x1

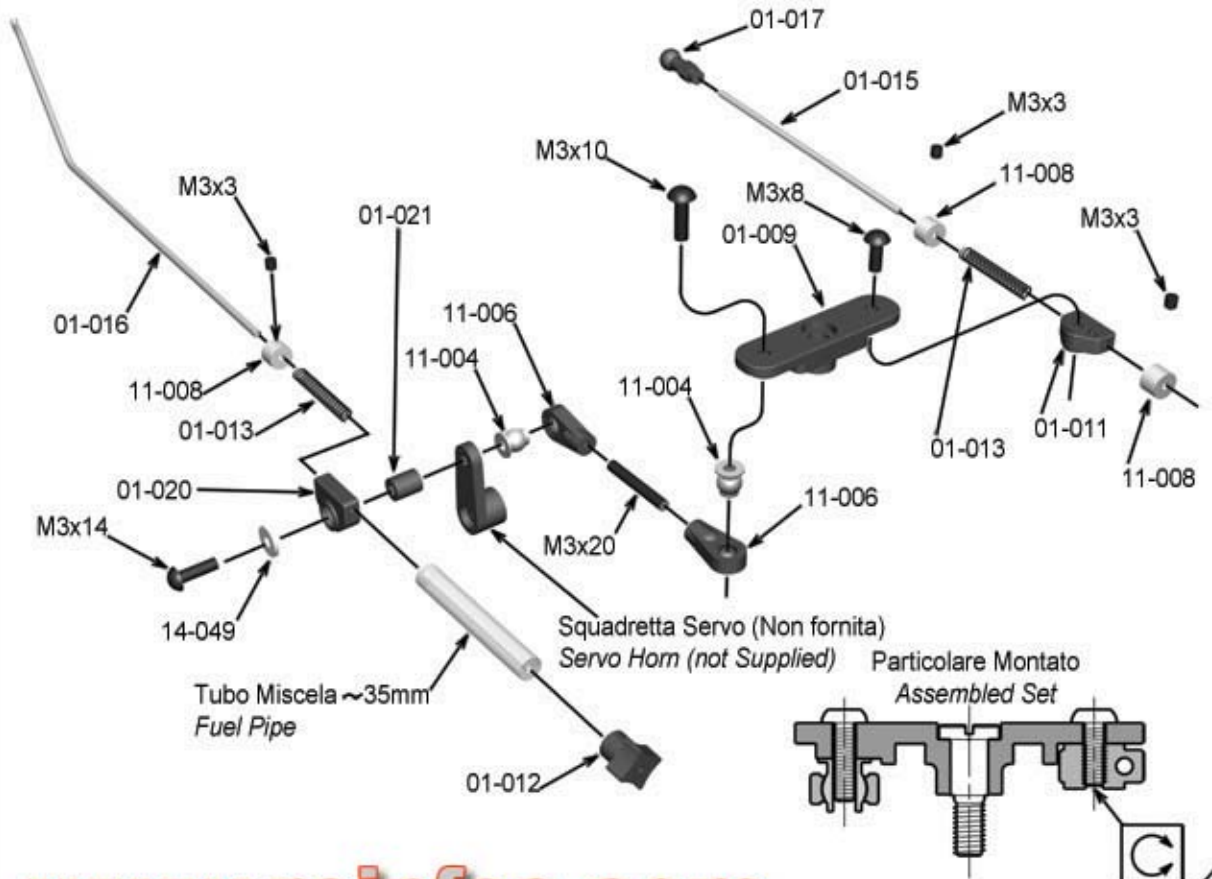

[www.rcinfos.com](http://www.rcinfos.com)

### Installazione Tiranteria Tie-Rods Installation



14-002  
M3x8 x2



14-001  
M3x6 x1



01-010  
M4x7 x1



14-018  
M3x3 x1

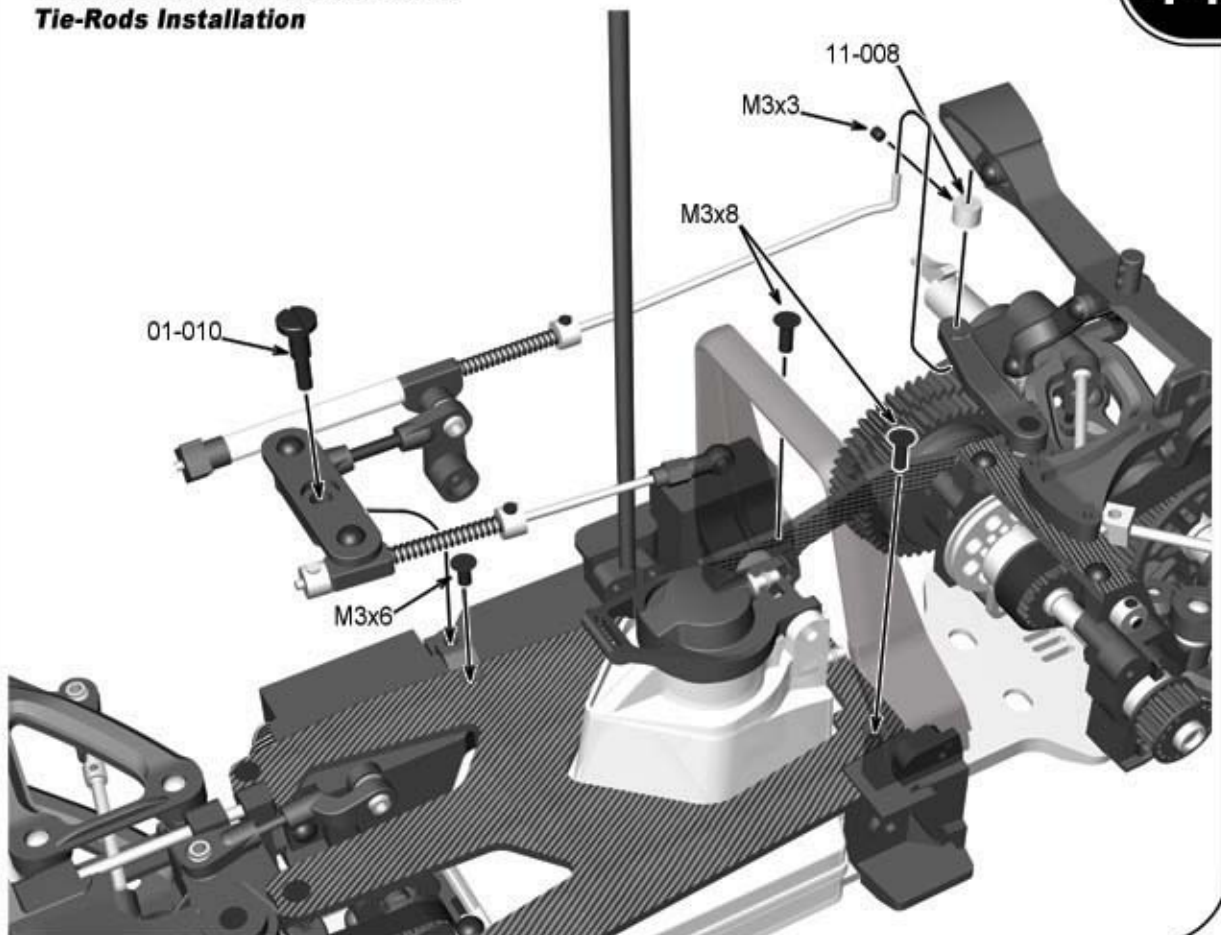

45

**Anteriore x2**  
*Front*

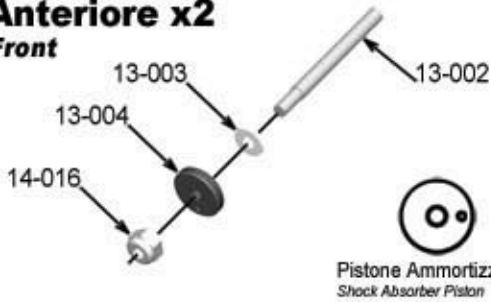

Pistone Ammortizzatore  
*Shock Absorber Piston*

**Posteriore x2**  
*Rear*

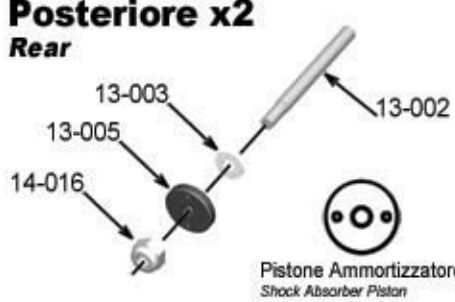

Pistone Ammortizzatore  
*Shock Absorber Piston*



O-Ring  
Ø12x1,5  
13-007\_\_x4



Dado AB M2,5  
Nylon nut.  
14-016\_\_x4

**Assemblaggio Ammortizzatore x4**  
*Shock Absorber Assembly x4*

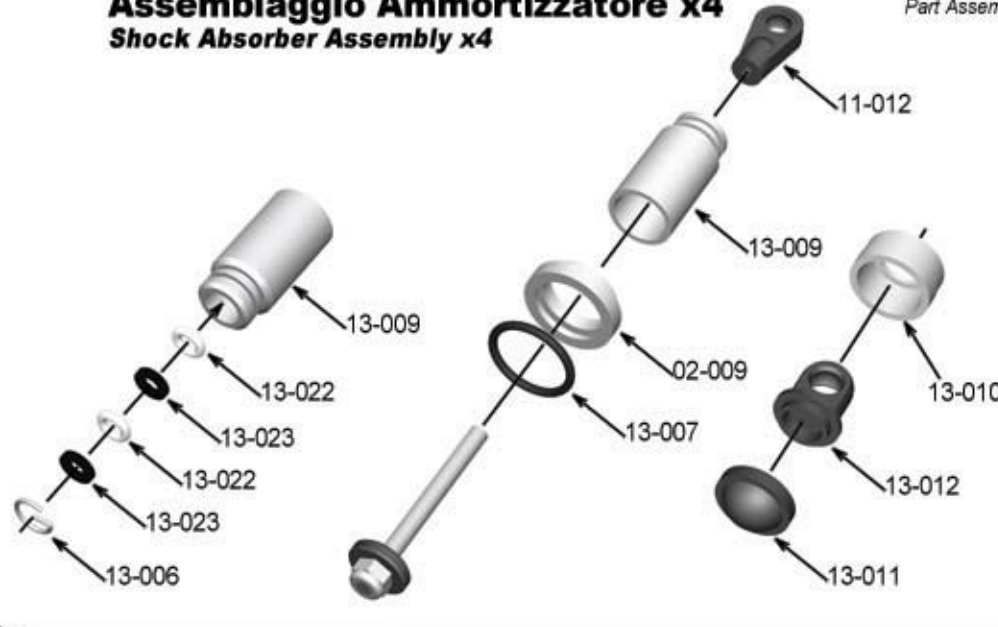

**Assemblaggio Particolare**  
*Part Assembly*



Accertarsi del perfetto scorrimento (eliminare eventuali sbavature dai particolari 13-004/13-005).  
*Test the proper working of the shock absorber (if necessary polish components number 13-004/13-005).*

46

[www.rcinfos.com](http://www.rcinfos.com)

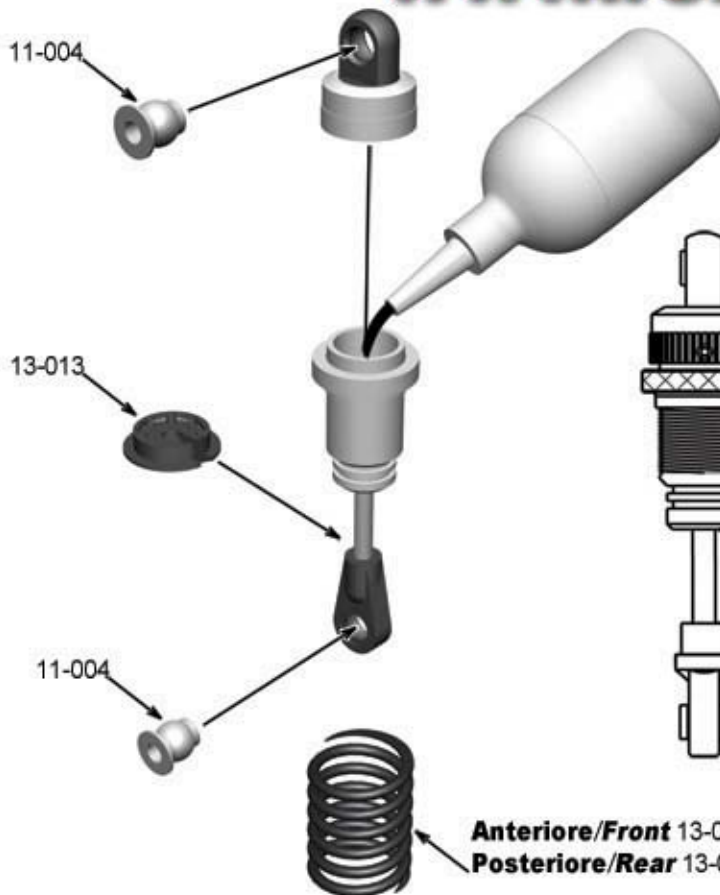

**Anteriore/Front** 10,5mm  
**Posteriore/Rear** 12mm



11-004\_\_x8

### Assemblaggio Frizione 1 Clutch Assembly 1

TC  
14-009  
M3x12 \_\_\_x4

Cuscinetto  
Ball Bearing  
Ø5xØ10x4  
09-002 \_\_\_x1

TC  
14-009  
M3x12 \_\_\_x1

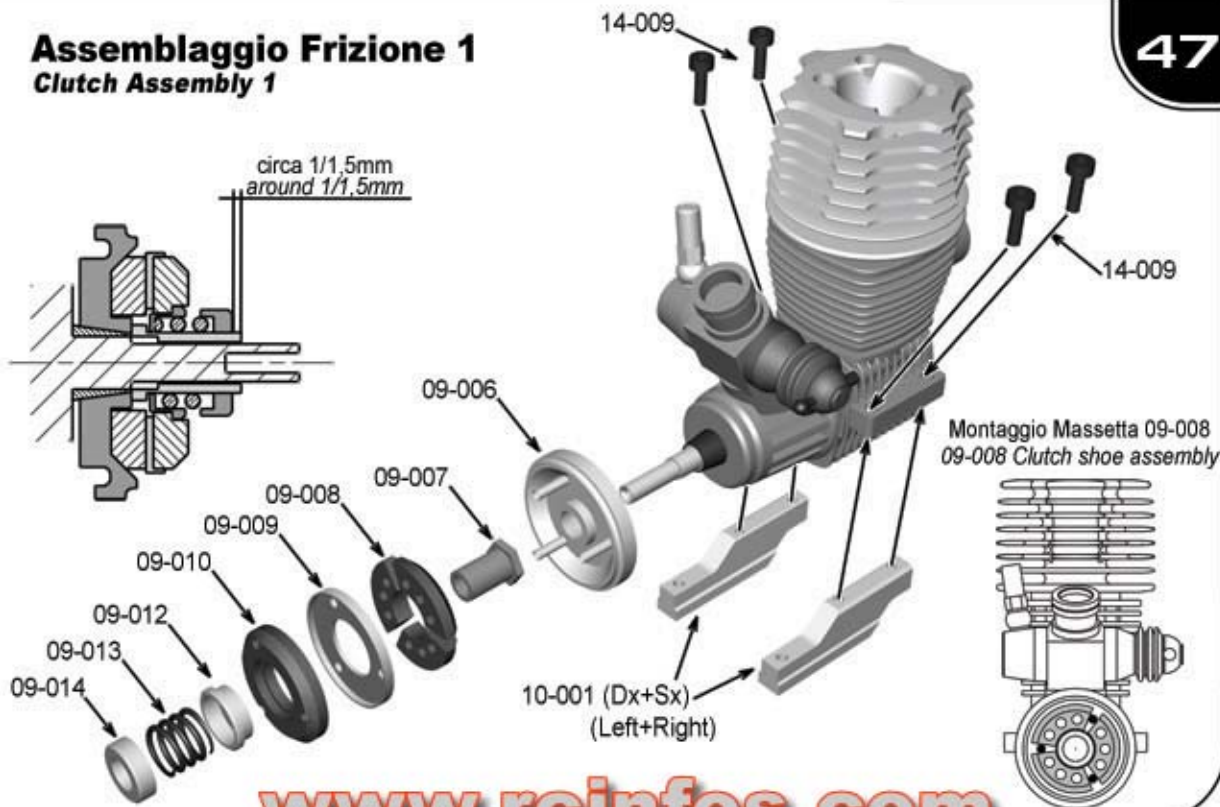

[www.rcinfos.com](http://www.rcinfos.com)

### Assemblaggio Frizione 2 Clutch Assembly 2



Dettaglio Particolare  
Part Detail  
Gioco finale Cuscinetto reggispinta.  
Final clearance thrust bearing.

0,1/0,15mm max  
Rasamenti/Washer

Cuscinetto Reggispinta Ø5xØ10x4  
Thrust Bearing Ø5xØ10x4

I fori del cod.09-005 sono differenti.  
The bores of 09-005 are different.  
Applicare grasso. Apply grease.

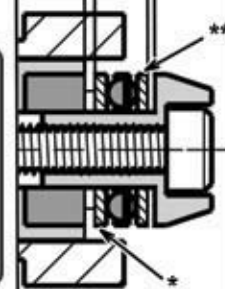

01  
1,2mm MAX  
1,2mm MAX

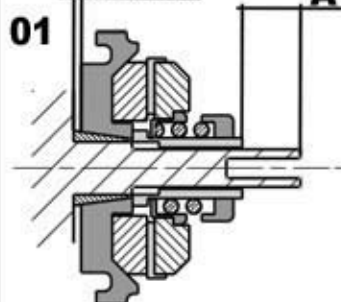

Misurare quota A  
Measure the dimension A

02  
Cuscinetto Ø5x10  
Ball Bearing

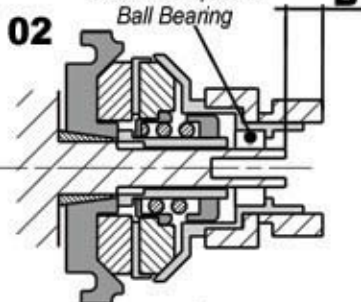

Inserire cuscinetto Ø5x10 e campana  
Portare campana a contatto con massetta  
Misurare quota B  
Place ball bearing Ø5x10 and clutch housing  
Put the clutch housing in touch with the clutch shoe  
Measure the dimension B  
**A+B+0,5mm=X**

03  
Cuscinetto Ø5x10  
Ball Bearing

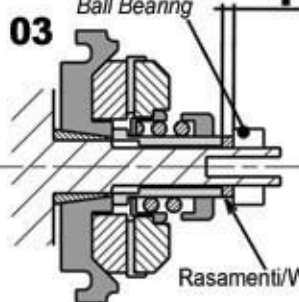

Per ottenere la distanza Y (rasamenti fra dado chiusura volano e cuscinetto post.) eseguire:  
To obtain the dimension Y (Washer between clutch nut and rear ball bearing) calculate:  
**X-11,6mm=Y**

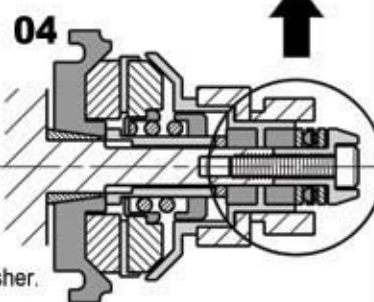



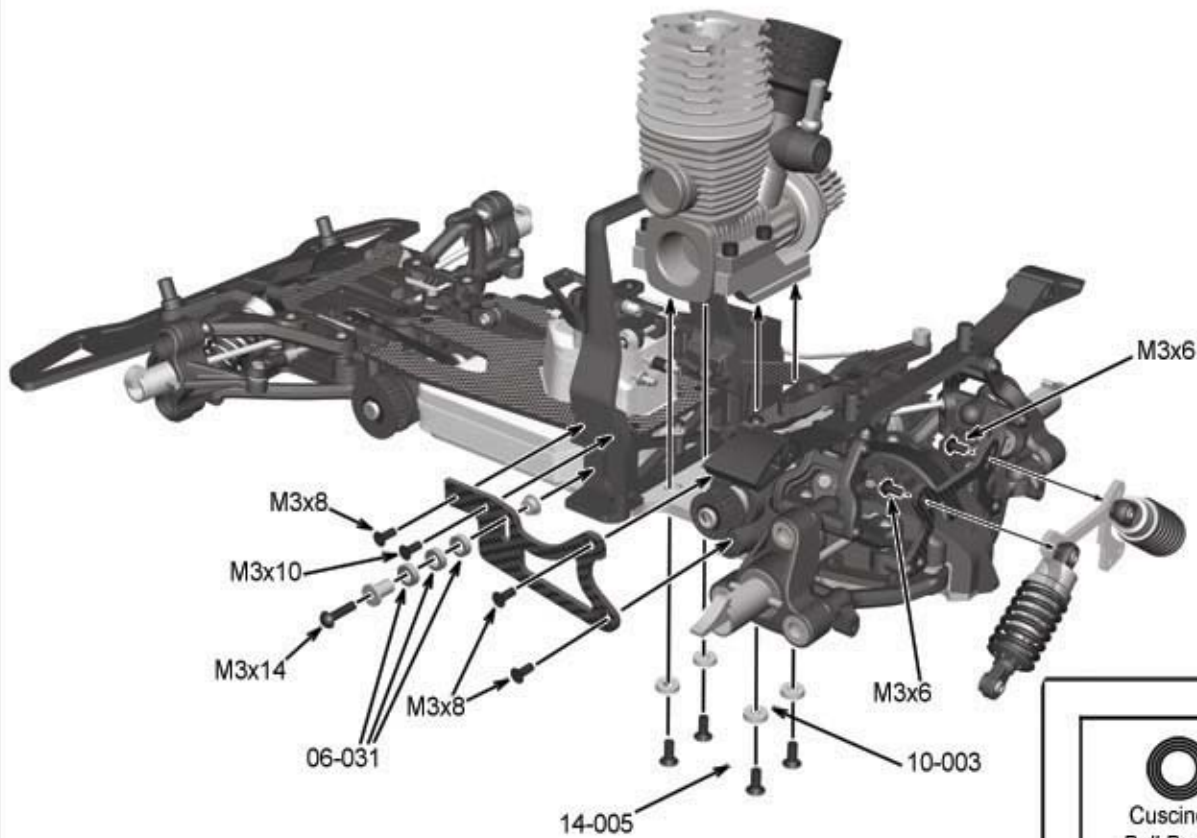

Completare montaggio frizione con campana, 2° cuscinetto Ø5x10 e cuscinetto reggispinta.  
Complete the clutch assembly with the clutch housing, the 2nd bearing and thrust bearing.

49

**Installazione motore e Ammortizzatori Post.**  
*Installation of Engine and Rear Shock Absorbers*

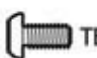

-  TS
- 14-003
- M3x10\_\_x1
- 
- Rondella  
Collar
- 10-003
- Ø10xØ4\_\_x4
- 
- TB
- 14-013
- M3x14\_\_x1
-  TS
- 14-002
- M3x8\_\_x3
- 
- TS
- 14-005
- M4x10\_\_x4
- 
- TB
- 14-007
- M3x6\_\_x2

- 
- Cuscinetto  
Ball Bearing
- 06-031
- Ø5xØ8x2,5\_\_x3

[www.rcinfos.com](http://www.rcinfos.com)

50

**Installazione Marmitta e Ammortizzatori Ant.**  
*Installation of Muffler and Front Shock Absorber*

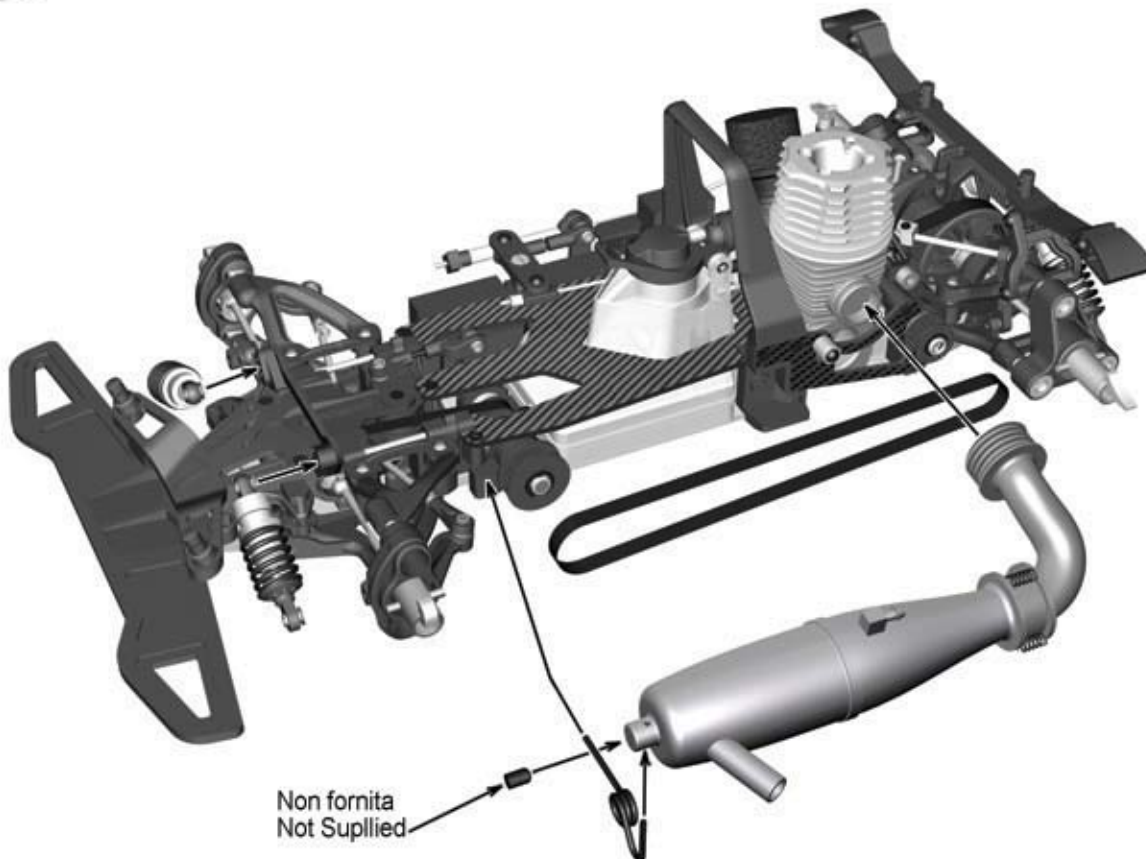

Non fornita  
Not Supplied



## Montaggio Ruote Wheels Installation

51

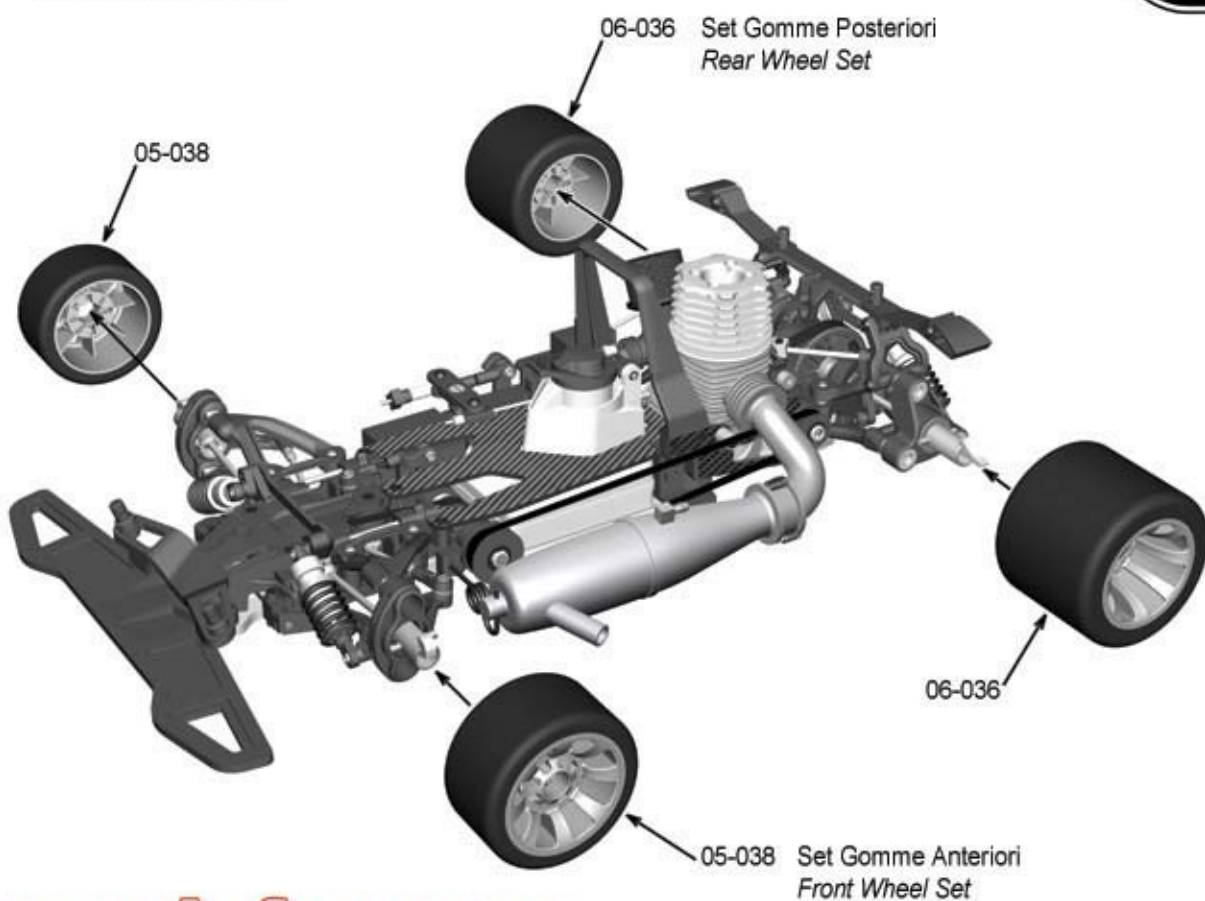

[www.rcinfos.com](http://www.rcinfos.com)



CLIPS  
05-003\_x4

## Montaggio Carrozzeria Body Installation

52

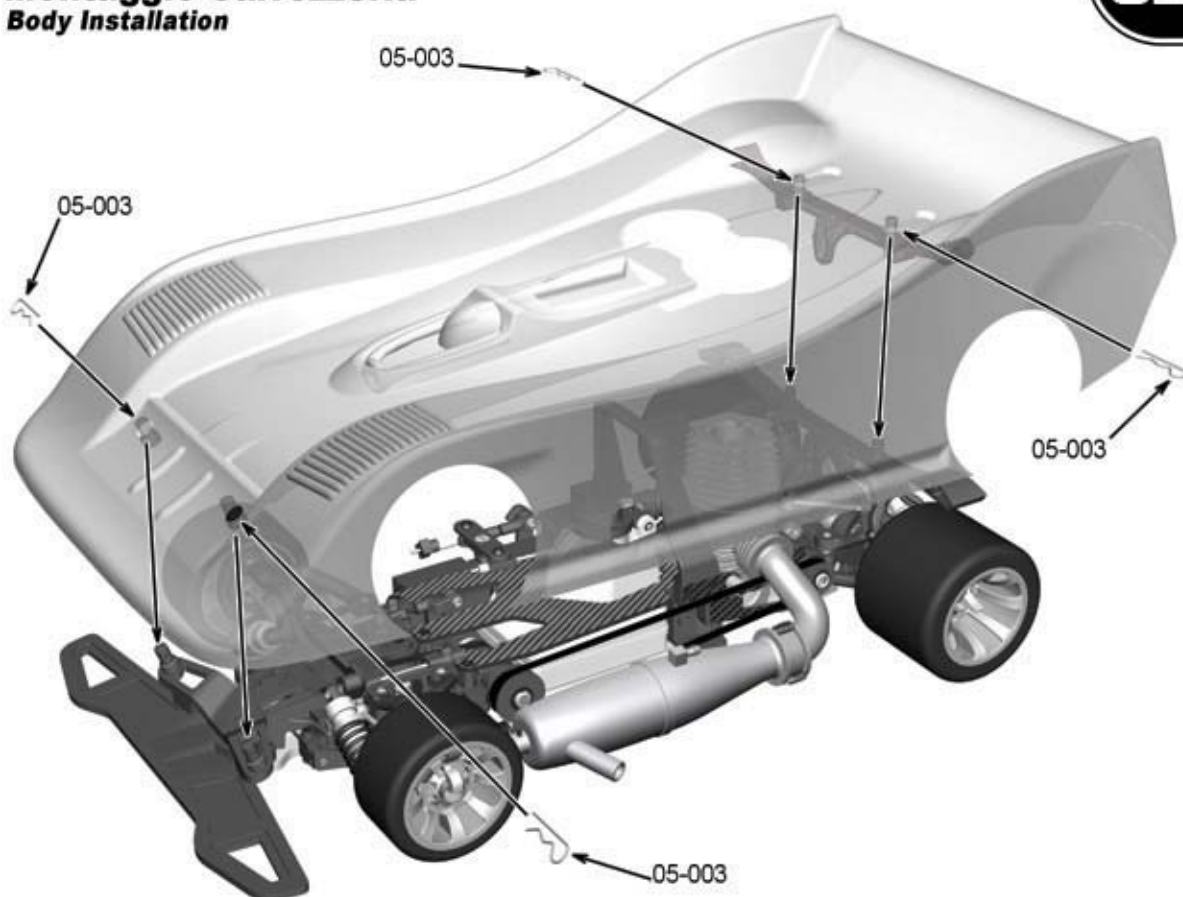

# KIT BAG A

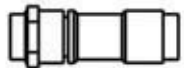

05-019 1pc.



05-036 2pcs.

05-042 1pcs.



24T

12-004 1pc.



25T

12-005 1pc.

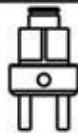

08-014 1pc.



05-027 3pcs.



O-RING  
DIAM. 12X1.5  
02-011 1pc.



05-024 2pcs.



16 T

12-001 1pc.



18T

12-002 1pc.



20T

12-003 1pc.



26T

12-006 1pc.



ROND./WASHER  
DIAM. 16.5  
12-009 1pc.



ROND./WASHER  
DIAM. 18.5  
12-010 1pc.



ROND./WASHER  
DIAM. 24.2  
12-011 1pc.



ROND./WASHER  
DIAM. 25.5  
12-012 1pc.



ROND./WASHER  
DIAM. 26.5  
12-013 1pc.

[www.rcinfos.com](http://www.rcinfos.com)

# KIT BAG B



02-007 1pc.



02-004 1pc.



05-032 1pc.



02-009 1pc.



O-RING  
DIAM. 12X1.5  
02-011 1pc.



02-008 1pc.

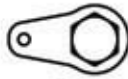

02-005 1pc.

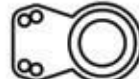

02-006 1pc.

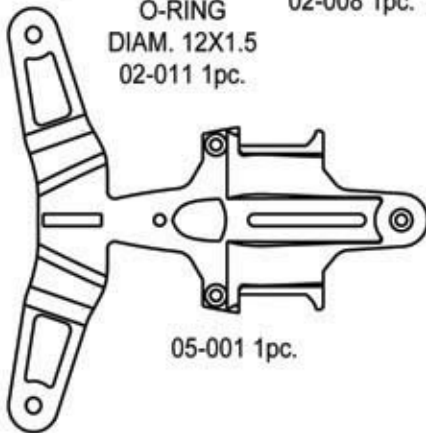

05-001 1pc.



02-002 2pc.



11-013 1pc.



DADO /NUT  
M4  
14-017 2pcs.

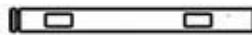

05-026 1pcs.

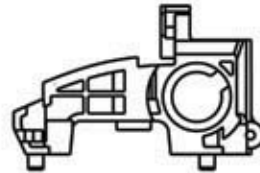

05-004 1pc.

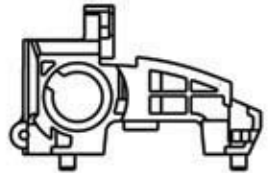

05-005 1pc.



05-023 1pc.



05-025 1pc.

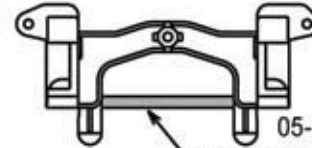

05-028 1pc.

Eliminare la parte grigia prima del Montaggio.  
Cut the Gray Part Off before Assembling.

# KIT BAG C



06-016 1pc.



07-005 2pcs.



07-008 1pc.

07-008 1pc.



07-006 1pc.



07-004 1pc.



14-048 1pc.

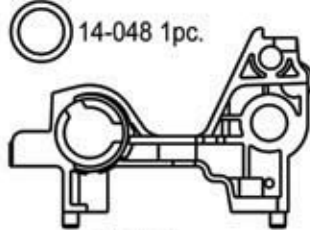

06-002 1pc.

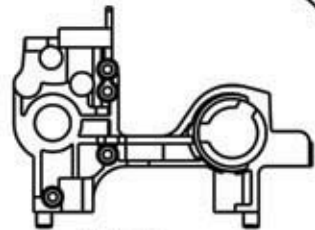

06-001 1pc.

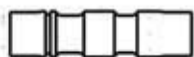

06-009 1pc.

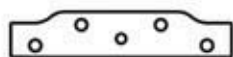

06-017 1pc.



06-034 2pcs.



06-018 2pc.

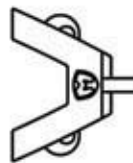

06-015 1pc.



06-014 1pc.



07-003 1pc.



48T  
12-007 1pc.



05-022 1pc.

ROND./WASHER  
DIAM. 3X6X0.5  
14-050 2pcs.



06-007 1pc.

# KIT BAG D

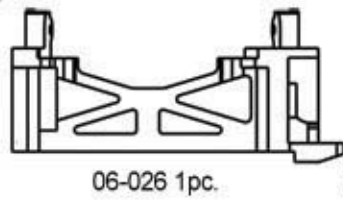
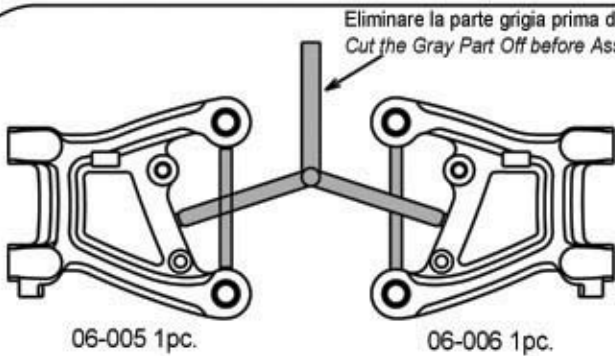

Eliminare la parte grigia prima del Montaggio.  
Cut the Gray Part Off before Assembling.

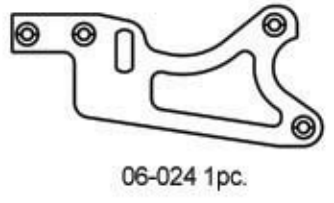
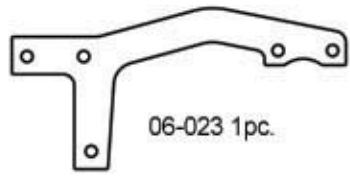
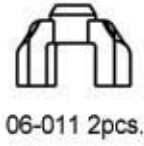
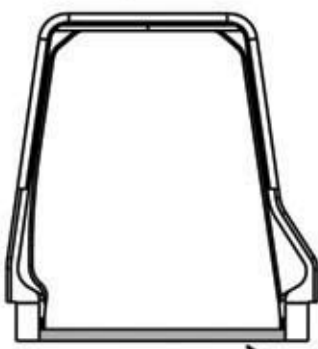
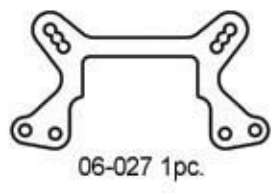
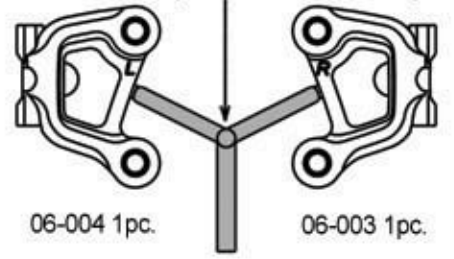

Eliminare la parte grigia prima del Montaggio.  
Cut the Gray Part Off before Assembling.

# KIT BAG D2



# KIT BAG D3



[www.rcinfos.com](http://www.rcinfos.com)

# KIT BAG E



08-021 1pc.

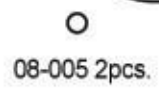
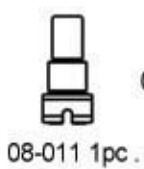
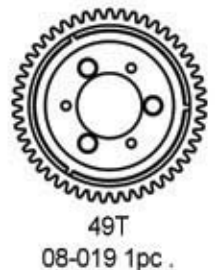
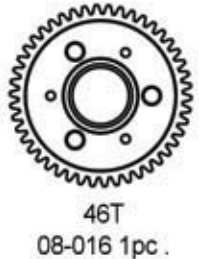

# KIT BAG F

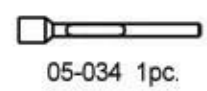
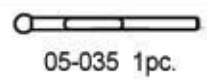
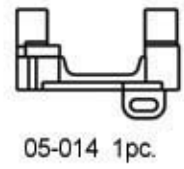
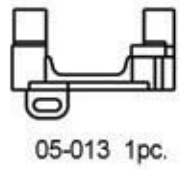
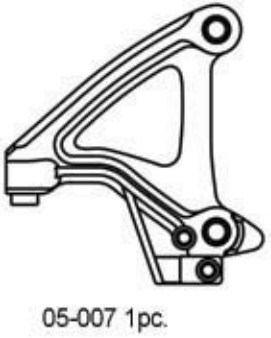

# KIT BAG F2

## KIT BAG G



05-015 2pcs.



06-033 2pcs.



05-012 2pcs.

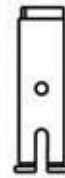

06-012 2pcs.

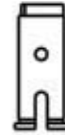

05-020 2pcs.



05-030 2pcs.



06-008 2pcs.



14-047 4pcs.



11-001 10pcs.



14-048 4pcs.



05-029 4pcs.

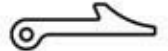

06-013 2pcs.

## KIT BAG H



06-022 2pcs.



01-002 1pc.



06-019 1pc.



06-021 1pc.



06-020 1pc.



01-018 2pcs.



01-019 2pcs.

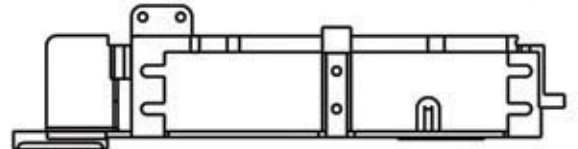

01-001 1pc.

## KIT BAG I



03-005 1pc.



03-007 4pcs.

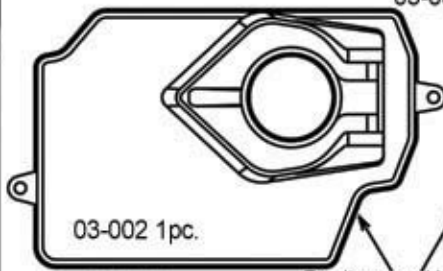

03-002 1pc.

03-009 1pc.

Fornito assemblato  
Supplied assembled

03-001 1pc.

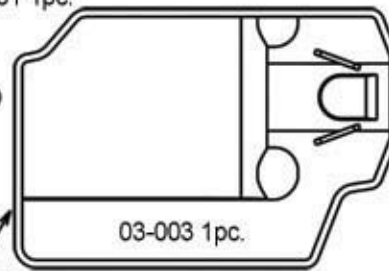

03-003 1pc.



03-006 1pc.



03-011 1pc.



03-010 1pc.



03-004 4pcs.



03-008 1pc.

## KIT BAG L

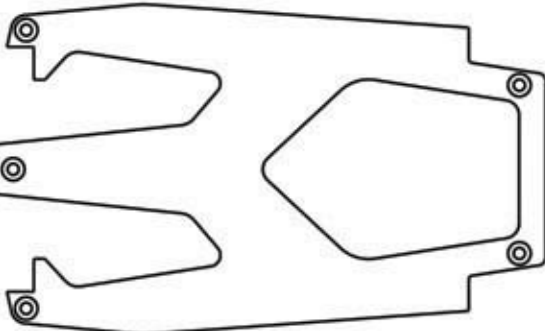

04-003 1pc.

## KIT BAG M



01-009 1pc.



01-012 1pc.



11-008 4pcs.



01-010 1pc.



01-013 2pcs.

01-015 1pc.

ROND./WASHER  
DIAM. 3X8X0.5  
14-045 1pc.

01-016 1pc.

## KIT BAG N



13-014 2pcs.



13-015 2pcs.



13-009 4pcs.



13-010 4pcs.



02-009 4pcs.



13-011 4pcs.



13-022 8 pcs.



13-006 4pcs.



13-003 4pcs.



DADO /NUT  
M2,5  
14-016 4pcs.



13-013 4pcs.



13-007 4pcs.



13-002 4pcs.

### KIT BAG O

### KIT BAG P

### KIT BAG Q

### KIT BAG R

[www.rcinfos.com](http://www.rcinfos.com)

### KIT BAG S

### KIT BAG S1

### KIT BAG S2

### KIT BAG S3

## KIT BAG T



DIAM.2,5x11,8  
14-036 1pc.

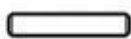

DIAM.2,5x15,8  
14-037 2pcs.



DIAM.3x24  
14-038 4pcs.



DIAM.3x25  
14-039 1pc.

## KIT BAG U



DIAM.12x18x4  
11-010 12pcs.



DIAM.10x15x4  
08-002 2pcs.



DIAM.6x13x5  
11-015 4pcs.



DIAM.6x10x3  
02-010 3pcs.



DIAM.5x10x4  
09-005 1pc.



DIAM.5x10x4  
09-002 2pcs.



DIAM.5x8x2,5  
06-031 3pcs.



DIAM.3x8x3  
06-010 3pcs.

## KIT BAG V



01-022 1pc.



01-008 1pc.

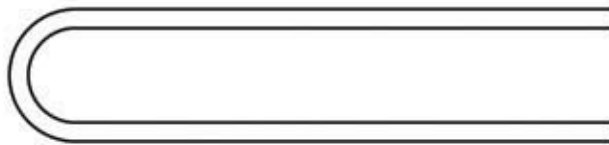

03-012 1pc.

## KIT BAG Z

04-005 1pc.

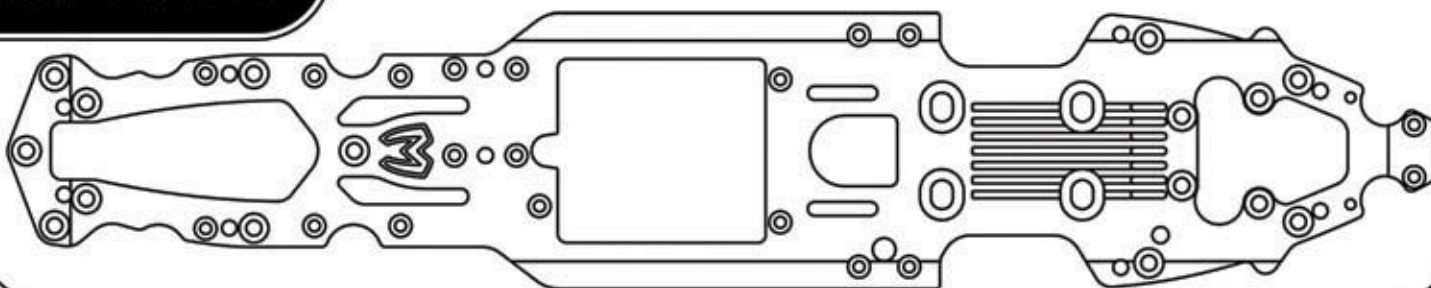

## EXTRA 1



E-Ring Ø1,9  
14-026 1pc.



E-Ring Ø4  
14-029 1pc.



E-Ring Ø5  
14-030 1pc.



E-Ring Ø7  
14-032 1 pc.



C-Ring Ø12  
14-034 1pc.



TSEI M3X6  
14-001 2pcs.



TSEI M3X8  
14-002 2pcs.



TSEI M3X10  
14-003 2pcs.



TSEI M3X14  
14-004 2pcs.



TSEI M4X10  
14-005 2pcs.



TSEI M4X12  
14-006 2pcs.



TBEI M3X6  
14-007 2pcs.



TBEI M3X8  
14-008 2pcs.



TCEI M3X12  
14-009 2pcs.

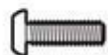

TBEI M3X10  
14-011 2pcs.

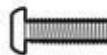

TBEI M3X12  
14-012 2pcs.

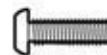

TBEI M3X14  
14-013 2pcs.



TBEI M4X10  
14-015 2pcs.

## EXTRA 2



13-003 1pc.



DADO /NUT  
M2,5  
14-016 1pc.



13-022 1pc.



13-006 1pc.



13-011 1pc.

# OPTIONAL



13-016 2pcs.



13-017 2pcs.



13-019 2pcs.



13-018 2pcs



09-016 1pc.



09-018 1pc.



09-019 1pc.



09-021 1pc.



08-015 1pc.



08-017 1pc.



08-018 1pc.



08-020 1pc.

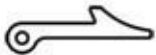

06-013 1pc.



05-030 1pc.

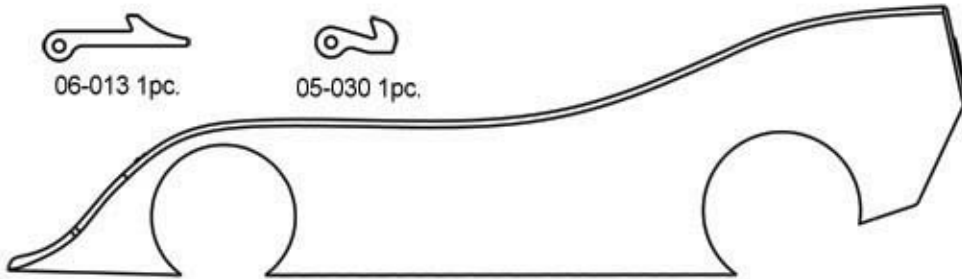

16-001 1pc.

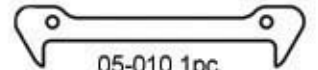

05-010 1pc.  
Rinforzo Carbonio  
Carbon fiber Stiffener

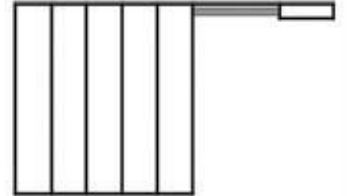

15-001 pc.  
Paccobatterie GP AAA 6V  
950 MAH con cavetto BEC  
Battery GP AAA 6V  
950 MAh with connector BEC



05-015 1pc.



06-008 1pc.

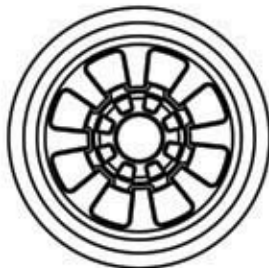

05-038 2pcs.

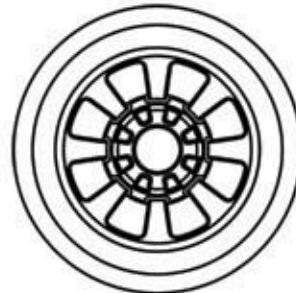

06-036 2pcs.

[www.rcinfos.com](http://www.rcinfos.com)

NOTES

---

---

---

---

---

---

---

---



- 4WD con trasmissione a cinghia
- Cambio a 2 velocità
- Frizione a doppia massetta
- Centro di rollio regolabile su sfere
- Barra antirollio anteriore regolabile
- Barra antirollio posteriore regolabile
- Rotazione barra a/r posteriore su cuscinetti
- Fine corsa sosp. ant./post. regolabili
- Angolo di Ackerman regolabile
- Tendi cinghia
- Regolazione tensione cinghia anteriore
- Rimozione facile e veloce impianto radio e tiranteria per manutenzione modello
- Contenitore batteria ad altezza telaio
- Telaio Ergal 70-75 sp. 5 mm.
- Serbatoio 125 c.c. con filtro miscela
- Completamente cuscinettata



- Belt Drive 4WD
- Shoe Type 2 Speed Gear Box
- Double Shoe Type Clutch
- On ball adjustable Roll Centre
- Adjustable (Angle) Front Anti-Roll Bar
- Adjustable (Angle) Rear Anti-Roll Bar
- On Bearing assembled Rear Anti-Roll Bar
- Adjustable Front/Rear Bump Stop/Rebound Stop
- Adjustable (Ackerman) Servo Saver
- Belt Tensioner
- Front Belt Tension Adjustment
- Easy removal of Radio Set and tie-rods Package for quick Maintenance
- Battery-Holder at chassis level
- 5mm (a70-75) chassis
- 125 c.c. Low Height Fuel Tank, Filter-equipped
- Full Ball Bearing

**DATI TECNICI**

Lunghezza	440mm
Larghezza	262mm
Passo	295mm
Angolo Caster	6.5° / 14 Reg.
Motore	classe .21

**TECHNICAL DATA**

Length	440mm
Width	262mm
Wheel Base	295mm
F.caster Angle	6.5° / 14 Adjustable
Engine	.21 class

 **MOTONICA**  
IS REGISTERED TRADE MARK OF FASTOM S.R.L.

 **FASTOM**

FASTOM S.r.l. Via Fratelli de Maistre 15/A - 10127 - Torino - Italia  
tel/fax +39 011 6165386

www.fastom.com

www.motonica.com